

Q-TECH CORPORATION						
Q-TECH CORPORATION Model Number	Andon Part Number Replace "XXX" with Terminal Type	Terminal Type		Pin Ø [in]	Figure Number	Page Number
		Thru-Hole	Surface Mount			
QT589	C10-306-04-01-XXX-R27-L14	01S	93S	.018	4	2
QT89	C10-306-04-01-XXX-R27-L14	01S	93S	.018	4	2
QT489	C10-306-04-01-XXX-R27-L14	01S	93S	.018	4	2
QT581	CSP192-04-01-XXX-R27-L14	01S	93S	.018	7	2
QT481	CSP192-04-01-XXX-R27-L14	01S	93S	.018	7	2
QT81	CSP192-04-01-XXX-R27-L14	01S	93S	.018	7	2
QT1	R200-0808-01T-XXX-R27-L14	75S	265S	.018	5	2
QT2	R300-SP12-01T-XXX-R27-L14	75S	265S	.018	6	2
QT3	R280-0808-02T-XXX-R27-L14	01S	93S	.018	8	2
QT14	R200-0808-01T-XXX-R27-L14	75S	265S	.018	5	2
QCC570LVDS	605D-06B-SM-G10-L14-X	-	-	-	13	3
QCC570LVPECC	605D-06B-SM-G10-L14-X	-	-	-	13	3
QCC325 SERIES	605D-04B-SM-G10-L14-X	-	-	-	15	4
QT 84	606D-04A-SM-G10-L14-X	-	-	-	14	4
QT484	606D-04A-SM-G10-L14-X	-	-	-	14	4
QT62	620-44-SM-G10-L14-X	-	-	-	16	4
QT66	680-40-SM-G10-L14-X	-	-	-	17	5
QT70	680-48-SM-G10-L14-X	-	-	-	18	5
QT71	620-28-SM-G10-L14-X	-	-	-	19	5
QT4, QT6, QT10, QT12, QT48	C10-314-14-01-XXX-R27-L14	01S	93S	.018	2	1
QT106, QT206, QT306	C10-314-14-01-XXX-R27-L14	01S	93S	.018	2	1
QT606, QT906S, QT18	C10-314-14-01-XXX-R27-L14	01S	93S	.018	2	1
QT41, QT141, QT641C	C10-314-04-01-XXX-R27-L14	01S	93S	.018	1	1
QT241, QT341, QT941S	C10-314-04-01-XXX-R27-L14	01S	93S	.018	1	1
QT42V, QT42, QT142	C10-314-04-01-XXX-R27-L14	01S	93S	.018	1	1
QT242, QT342	C10-314-04-01-XXX-R27-L14	01S	93S	.018	1	1
QT50	C10-308-04-02-XXX-R27-L14	01S	93S	.018	3	2
QT50V	C10-308-04-02-XXX-R27-L14	01S	93S	.018	3	2
QT55	C10-308-04-02-XXX-R27-L14	01S	93S	.018	3	2
QT57, QT57V, QT957S	C10-616-16-01-XXX-R27-L14	01S	93S	.018	9	3
QTV701 TO QTV706	C10-324-24-01-XXX-R27-L14	01S	93S	.018	10	3
QT801 TO QT806	C10-324-24-01-XXX-R27-L14	01S	93S	.018	10	3
QT901S	C10-318-18-01-XXX-R27-L14	01S	93S	.018	11	3
QPD-0005	C10-7524-09-01-XXX-R27-L14	295V	439V	.030	12	3

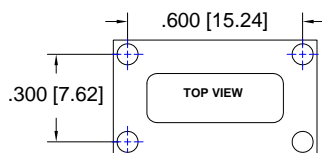

FIG.1

Thru-Hole: C10-314-04-01-01S-R27-L14
Surface Mount: C10-314-04-01-93S-R27-L14

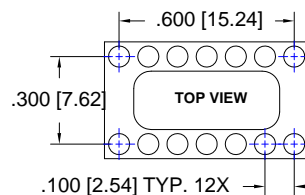

FIG.2

Thru-Hole: C10-314-14-01-01S-R27-L14
Surface Mount: C10-314-14-01-93S-R27-L14

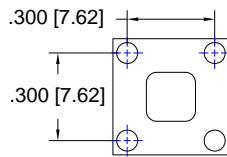

FIG.3

Thru-Hole: C10-308-04-02-01S-R27-L14
Surface Mount: C10-308-04-02-93S-R27-L14

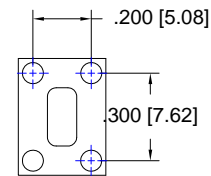

FIG.4

Thru-Hole: C10-306-04-01-01S-R27-L14
Surface Mount: C10-306-04-01-93S-R27-L14

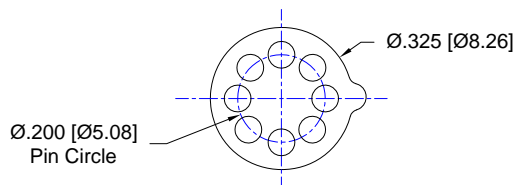

FIG.5

Thru-Hole: R200-0808-01T-75S-R27-L14
Surface Mount: R200-0808-01T-265S-R27-L14

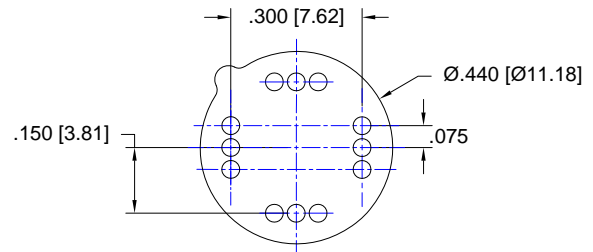

FIG.6

Thru-Hole: R300-SP12-01T-75S-R27-L14
Surface Mount: R300-SP12-01T-265S-R27-L14

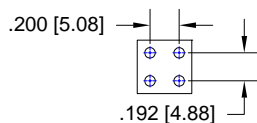

FIG.7

Thru-Hole: CSP192-04-01-01S-R27-L14
Surface Mount: CSP192-04-01-93S-R27-L14

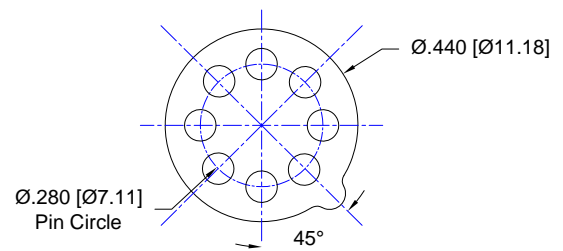

FIG.8

Thru-Hole: R280-0808-02T-01S-R27-L14
Surface Mount: R280-0808-02T-93S-R27-L14

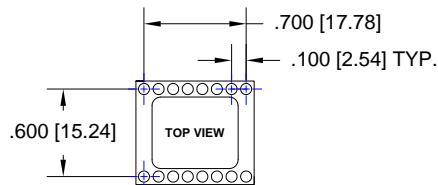

FIG.9

Thru-Hole: C10-616-16-01-01S-R27-L14
Surface Mount: C10-616-16-01-93S-R27-L14

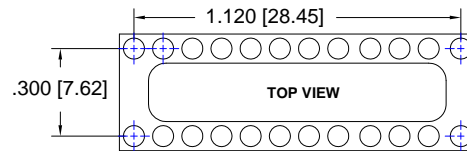

FIG.10

Thru-Hole: C10-324-24-01-01S-R27-L14
Surface Mount: C10-324-24-01-93S-R27-L14

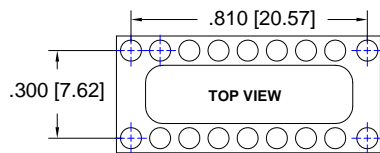

FIG.11

Thru-Hole: C10-318-18-01-01S-R27-L14
Surface Mount: C10-318-18-01-93S-R27-L14

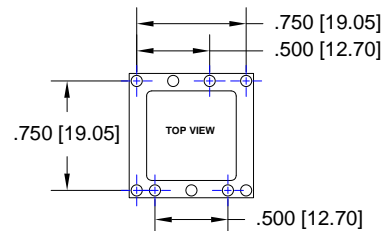

FIG.12

Thru-Hole: C10-7524-09-01-295V-R27-L14
Surface Mount: C10-7524-09-01-439V-R27-L14

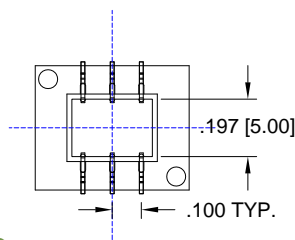
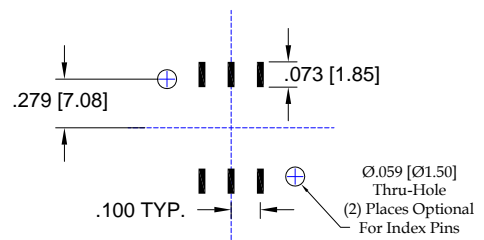

FIG.13

Thru-Hole: N/A
Surface Mount: 605D-06B-SM-G10-L14-X

WITHOUT INDEX PINS = -0
WITH INDEX PINS = -1



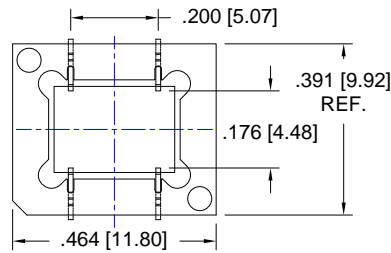

FIG.14

Thru-Hole: N/A

Surface Mount: 606D-04A-**SM**-G10-L14-X

WITHOUT INDEX PINS = -0
WITH INDEX PINS = -1

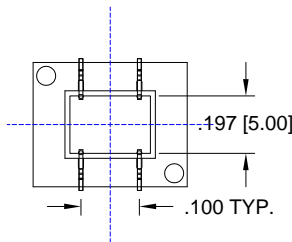
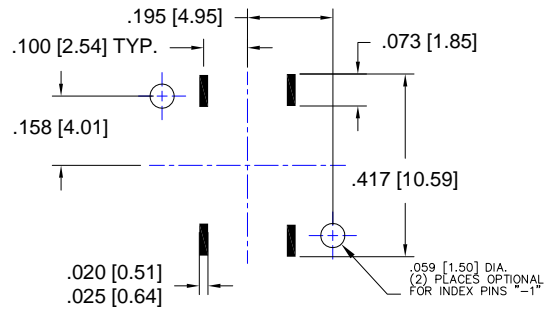

FIG.15

Thru-Hole: N/A

Surface Mount: 605D-04B-**SM**-G10-L14-X

WITHOUT INDEX PINS = -0
WITH INDEX PINS = -1

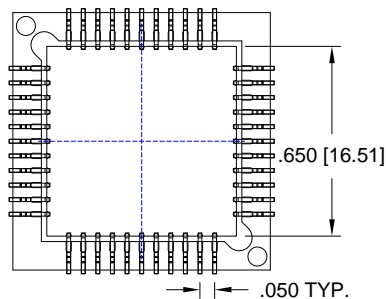
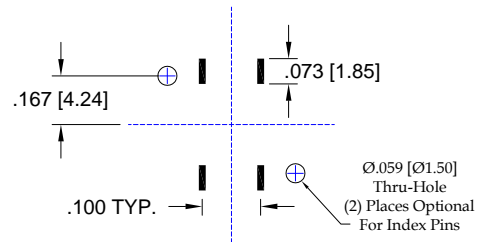
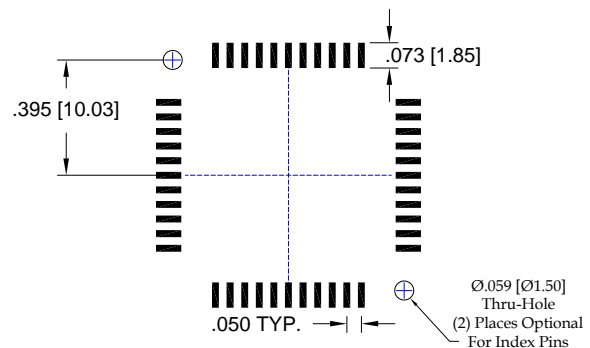

FIG.16

Thru-Hole: N/A

Surface Mount: 620-44-**SM**-G10-L14-X

WITHOUT INDEX PINS = -0
WITH INDEX PINS = -1



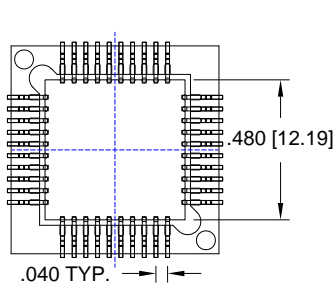

FIG.17

Thru-Hole: N/A

Surface Mount: 680-40-**SM**-G10-L14-X

WITHOUT INDEX PINS = -0
WITH INDEX PINS = -1

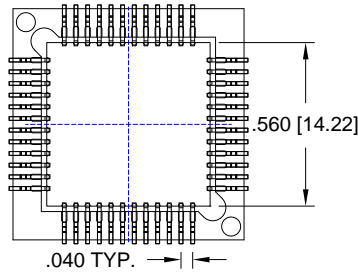
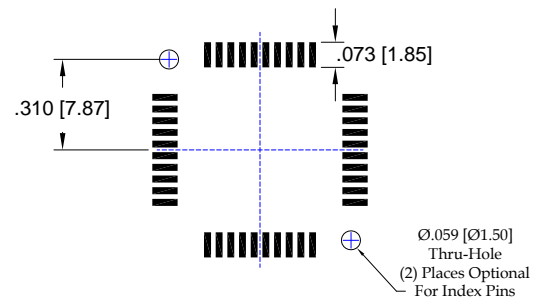

FIG.18

Thru-Hole: N/A

Surface Mount: 680-48-**SM**-G10-L14-X

WITHOUT INDEX PINS = -0
WITH INDEX PINS = -1

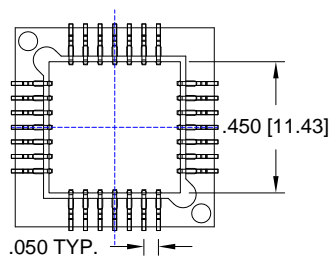
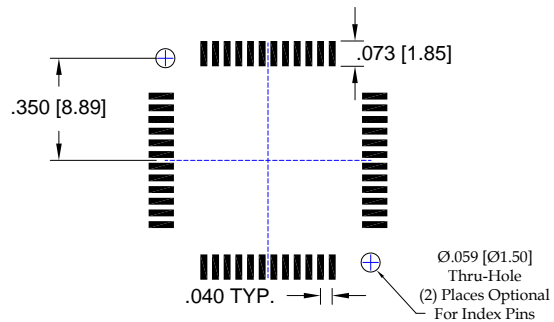
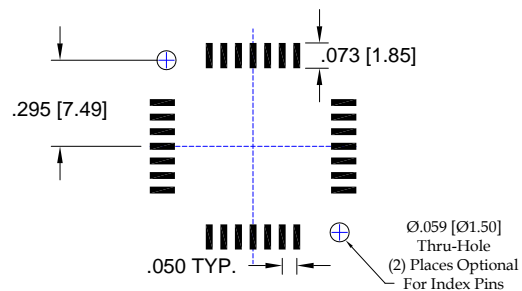

FIG.19

Thru-Hole: N/A

Surface Mount: 620-28-**SM**-G10-L14-X

WITHOUT INDEX PINS = -0
WITH INDEX PINS = -1



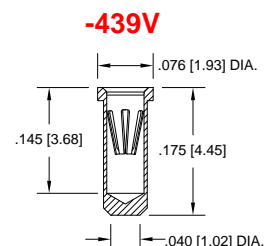
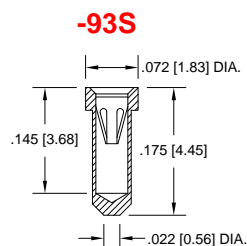
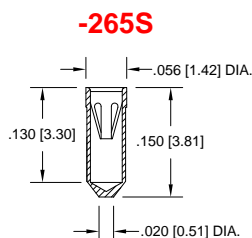
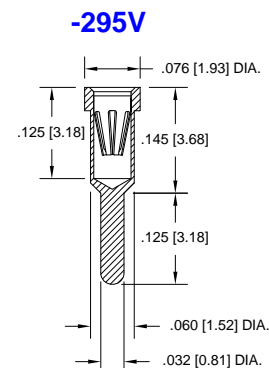
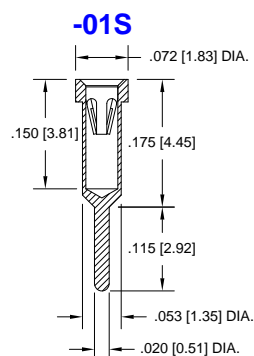
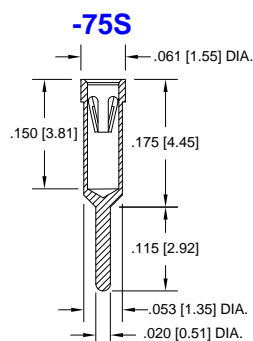

Technical Information

Material:

Insulator: Hi-Temp UL 94V-O
Terminal: Brass, per ASTM-B16
Contact: BeCu, Per ASTM-B194

Plating: RoHS COMPLIANT

R27 TERMINAL: GOLD / CONTACT: GOLD

R17 TERMINAL: TIN / CONTACT: GOLD

OTHER PLATINGS AVAILABLE

Terminal Acceptance and Forces

Thru Hole Terminals				Surface Mount Terminals			
Thru Hole Terminal	Accepts Pin Diameter	Insertion Force	Withdrawal Force	Surface Mount Terminal	Accepts Pin Diameter	Insertion Force	Withdrawal Force
-75S	Ø.018 [Ø1.46]	9.0 oz Avg.	2.0 oz Min	-265S	Ø.018 [Ø0.46]	9.0 oz Avg.	2.0 oz Min
-01S	Ø.018 [Ø0.46]	9.0 oz Avg.	2.0 oz Min	-93S	Ø.018 [Ø0.46]	9.0 oz Avg.	2.0 oz Min
-295V	Ø.030 [Ø0.76]	13.2 oz Max	3.5 oz Min	-439V	Ø.030 [Ø0.76]	13.2 oz Max	3.5 oz Min

MOUNTING OPTIONS

