

MMD Monitor/Quartztek						
MMD Monitor/Quartztek Model Number	Andon Part Number Replace "XXX" with Terminal Type	Terminal Type		Pin Ø [in]	Figure Number	Page Number
		Thru-Hole	Surface Mount			
AN SERIES	C10-002-02-02-XXX-R27-L14	400T4	414T4	.012	6	2
BHC 49/US-2 LEAD	CSP192-02-01-XXX-R27-L14	01S	93S	.018	3	2
BHC 49/US-3 LEAD	C10-003-03-01-XXX-R27-L14	01S	93S	.018	4	2
EHC 49/US-2 LEAD	CSP192-02-01-XXX-R27-L14	01S	93S	.018	3	2
EHC 49/US-3 LEAD	C10-003-03-01-XXX-R27-L14	01S	93S	.018	4	2
FT310	R043-0402-01T-XXX-R27-L14	400T4	414T4	.012	10	3
MA SERIES	C10-314-04-01-XXX-R27-L14	01S	93S	.018	11	3
MBH SERIES	C10-308-04-02-XXX-R27-L14	01S	93S	.018	7	2
MC-49	CSP192-02-01-XXX-R27-L14	01S	93S	.018	3	2
MOA	C10-7524-05-01-XXX-R27-L14	295V	439V	.030	8	2
MOB	C10-7524-05-01-XXX-R27-L14	295V	439V	.030	8	2
MOBC SERIES	C10-7524-05-01-XXX-R27-L14	01S	93S	.018	8	2
MOC	C10-7524-05-01-XXX-R27-L14	295V	439V	.030	8	2
MOD	C10-13628-05-01-XXX-R27-L14	436P55	440P55	.060	2	1
MOE SERIES	C10-1014-05-02-XXX-R27-L14	295V	439V	.030	5	2
MOF SERIES	C10-314-04-01-XXX-R27-L14	01S	93S	.018	11	3
MOH	C10-608-05-02-XXX-R27-L14	01S	93S	.018	1	1
MT	C10-314-04-01-XXX-R27-L14	01S	93S	.018	11	3
MTB	C10-314-04-01-XXX-R27-L14	01S	93S	.018	11	3
MTF	C10-314-04-01-XXX-R27-L14	01S	93S	.018	11	3
MQAC SERIES	C10-314-04-01-XXX-R27-L14	01S	93S	.018	11	3
MQBT SERIES	C10-308-04-02-XXX-R27-L14	01S	93S	.018	7	2
MVA SERIES	C10-314-04-01-XXX-R27-L14	01S	93S	.018	11	3
UM-1	C15-02-02-02-XXX-R27-L14	400T4	414T4	.012	9	3
WC38	R043-0402-01T-XXX-R27-L14	400T4	414T4	.012	10	3

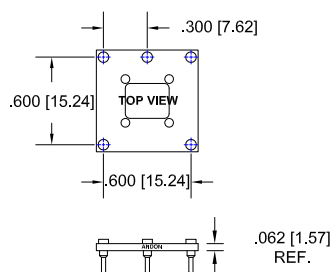

**Fig.1**

Thru-Hole: C10-608-05-02-**01S**-R27-L14  
Surface Mount: C10-608-05-02-**93S**-R27-L14

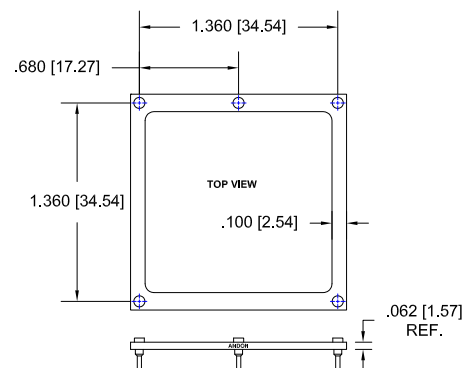
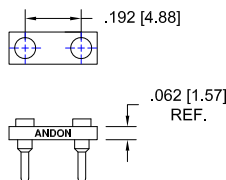

**Fig.2**

Thru-Hole: C10-13628-05-01-**436P55**-R27-L14  
Surface Mount: C10-13628-05-01-**440P55**-R27-L14

## MMD Monitor/Quartztek Continued

Top View Shown  
Units: in [mm]



**Fig.3**

Thru-Hole: CSP192-02-01-01S-R27-L14  
Surface Mount: CSP192-02-01-93S-R27-L14

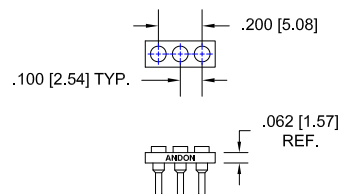

**Fig.4**

Thru-Hole: C10-003-03-01-01S-R27-L14  
Surface Mount: C10-003-03-01-93S-R27-L14

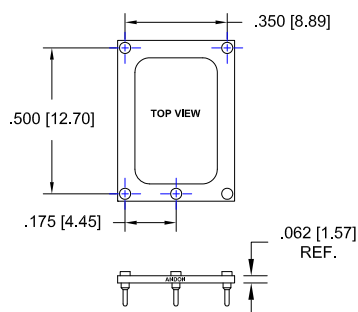

**Fig.5**

Thru-Hole: C10-1014-05-02-295V-R27-L14  
Surface Mount: C10-1014-05-02-439V-R27-L14

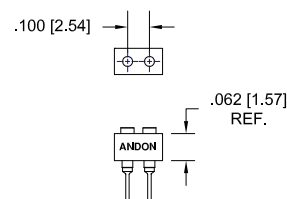

**Fig.6**

Thru-Hole: C10-002-02-02-400T4-R27-L14  
Surface Mount: C10-002-02-02-414T4-R27-L14

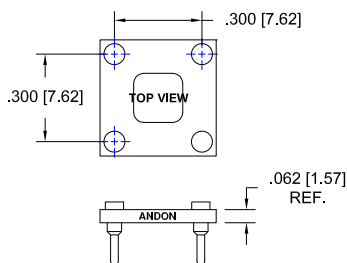

**Fig.7**

Thru-Hole: C10-308-04-02-01S-R27-L14  
Surface Mount: C10-308-04-02-93S-R27-L14

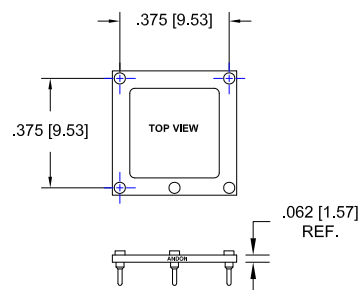
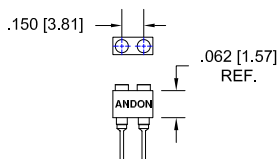

**Fig.8**

Thru-Hole: C10-7524-05-01-295V-R27-L14  
Surface Mount: C10-7524-05-01-439V-R27-L14

## MMD Monitor/Quartztek Continued

Top View Shown  
Units: in [mm]



**Fig.9**

Thru-Hole: C15-02-02-02-**400TA**-R27-L14  
Surface Mount: C15-02-02-02-**414TA**-R27-L14

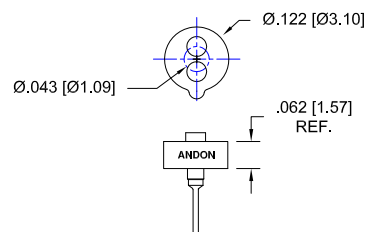

**Fig.10**

Thru-Hole: R043-0402-01T-**400T4**-R27-L14  
Surface Mount: R043-0402-01T-**414T4**-R27-L14

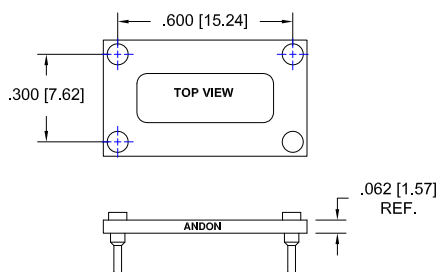
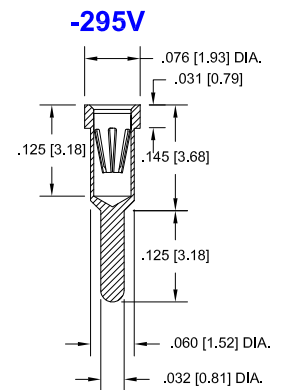
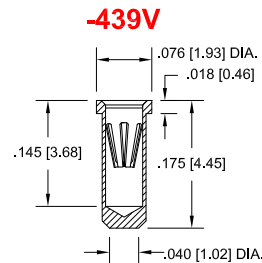
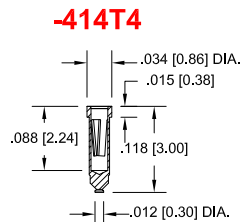
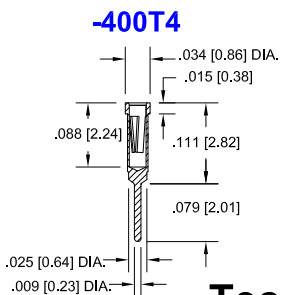
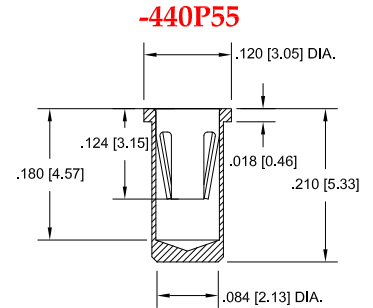
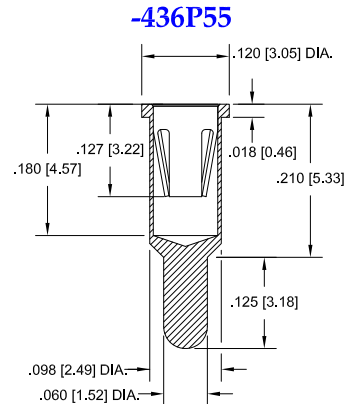
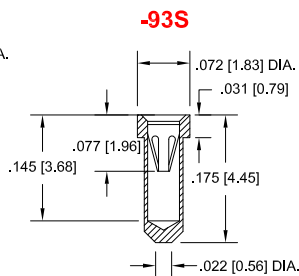
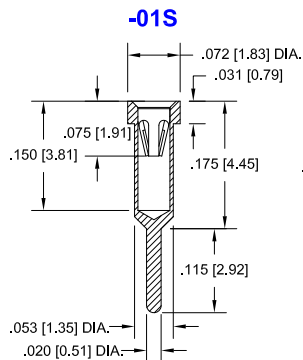

**Fig.11**

Thru-Hole: C10-314-04-01-**01S**-R27-L14  
Surface Mount: C10-314-04-01-**93S**-R27-L14

## MMD Monitor/Quartztelk Continued

### Socket Terminal Details Cross Section View Shown Units: in [mm]



## Technical Information

### Material:

Insulator: Hi-Temp UL 94V-0  
Terminal: Brass, per ASTM-B16  
Contact: BeCu, Per ASTM-B194

### Plating: RoHS COMPLIANT

**R15 TERMINAL: GOLD / CONTACT: GOLD**  
**R17 TERMINAL: TIN / CONTACT: GOLD**  
**OTHER PLATINGS AVAILABLE**

Terminal Acceptance and Forces							
Thru Hole Terminals				Surface Mount Terminals			
Thru Hole Terminal	Accepts Pin Diameter	Insertion Force	Withdrawal Force	Surface Mount Terminal	Accepts Pin Diameter	Insertion Force	Withdrawal Force
<b>-01S</b>	Ø.018 [Ø0.46]	9.0 oz Avg.	2.0 oz Min	<b>-93S</b>	Ø.018 [Ø0.46]	9.0 oz Avg.	2.0 oz Min
<b>-295V</b>	Ø.030 [Ø0.76]	13.2 oz Max	3.5 oz Min	<b>-439V</b>	Ø.030 [Ø0.76]	13.2 oz Max	3.5 oz Min
<b>-436P55</b>	Ø.060 [Ø1.52]	15.5 oz Max	2.1 oz Min	<b>-440P55</b>	Ø.060 [Ø1.52]	15.5 oz Max	2.1 oz Min
<b>-400T4</b>	Ø.012 [Ø0.30]	1.1 oz Max	0.3 oz Min	<b>-281K</b>	Ø.012 [Ø0.30]	1.1 oz Max	0.3 oz Min

### MOUNTING OPTIONS

