



ANDON
INTERCONNECTION SPECIALISTS



RoHS Compliant
ISO 9001
Certified

HIGH RELIABILITY CRYSTALS SOCKETS FOR

MDX
TIME AND FREQUENCY CONTROL DEVICES

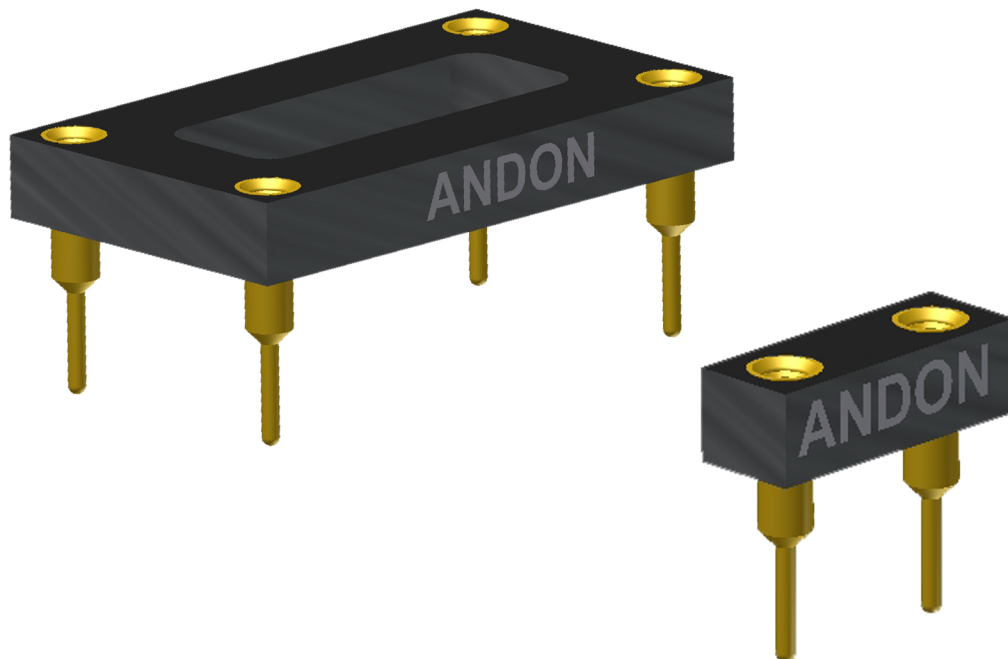

Featuring Andon's Unique Senstac™ Contact

MDX is a trade mark of MDX

MDX						
MDX Model Number	Andon Part Number Replace "XXX" with Terminal Type	Terminal Type		Pin Ø [in]	Figure Number	Page Number
		Thru-Hole	Surface Mount			
M5U4 SERIES	CSP148-02-01-XXX-R27-L14	400T4	414T4	.012	1	1
M5U5 SERIES	CSP148-02-01-XXX-R27-L14	400T4	414T4	.012	1	1
METAL VCXO	C10-314-04-01-XXX-R27-L14	01S	93S	.018	3	1
MVTD-S SERIES	C10-314-04-01-XXX-R27-L14	01S	93S	.018	3	1
MVTD-H SERIES	C10-314-04-01-XXX-R27-L14	01S	93S	.018	3	1
MTD-H SERIES	C10-314-03-01-XXX-R27-L14	01S	93S	.018	4	1
MTD-H3 SERIES	C10-314-03-01-XXX-R27-L14	01S	93S	.018	4	1
MTD-T SERIES	C10-314-03-01-XXX-R27-L14	01S	93S	.018	4	1
MTD-S SERIES	C10-314-03-01-XXX-R27-L14	01S	93S	.018	4	1
M9S SERIES	CSP192-02-01-XXX-R27-L14	01S	93S	.018	2	1
MDX (49U) SERIES	CSP192-02-01-XXX-R27-L14	01S	93S	.018	2	1
DIL 14 TYPE	C10-314-04-01-XXX-R27-L14	01S	93S	.018	3	1
MCC/MHC-14	C10-314-04-01-XXX-R27-L14	01S	93S	.018	3	1
DIL 8 TYPE	C10-308-04-02-XXX-R27-L14	01S	93S	.018	5	1
MHH/MTD	C10-308-04-02-XXX-R27-L14	01S	93S	.018	5	1

Heat sink socket available to reduce heat and noise. Contact Andon for details.

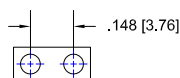

FIG.1

Thru-Hole: CSP148-02-01-400T4-R27-L14
Surface Mount: CSP148-02-01-414T4-R27-L14

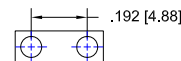

FIG.2

Thru-Hole: CSP192-02-01-01S-R27-L14
Surface Mount: CSP192-02-01-93S-R27-L14

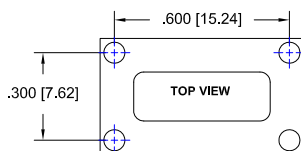

FIG.3

Thru-Hole: C10-314-04-01-01S-R27-L14
Surface Mount: C10-314-04-01-93S-R27-L14

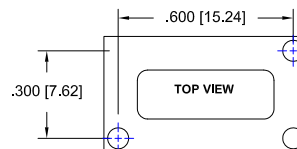

FIG.4

Thru-Hole: C10-314-03-01-01S-R27-L14
Surface Mount: C10-314-03-01-93S-R27-L14

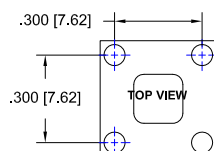
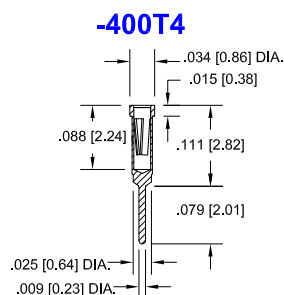
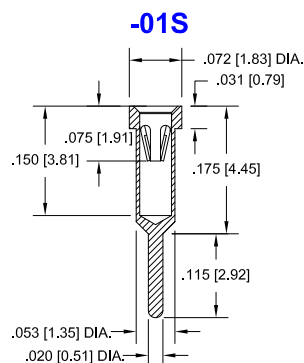
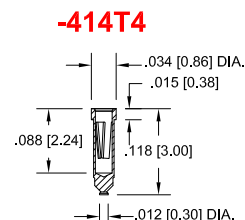
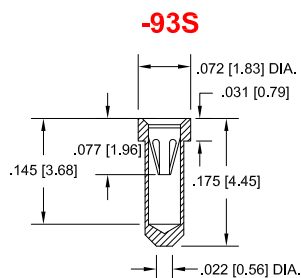

FIG.5

Thru-Hole: C10-308-04-02-01S-R27-L14
Surface Mount: C10-308-04-02-93S-R27-L14

MDX Continued
Top View Shown
Units: in [mm]



Technical Information

Material:

Insulator: Hi-Temp UL 94V-O
Terminal: Brass, per ASTM-B16
Contact: BeCu, Per ASTM-B194

Plating: RoHS COMPLIANT

R15 TERMINAL: GOLD / CONTACT: GOLD

R17 TERMINAL: TIN / CONTACT: GOLD

OTHER PLATINGS AVAILABLE

Terminal Acceptance and Forces

Thru Hole Terminals				Surface Mount Terminals			
Thru Hole Terminal	Accepts Pin Diameter	Insertion Force	Withdrawal Force	Surface Mount Terminal	Accepts Pin Diameter	Insertion Force	Withdrawal Force
-400T4	Ø.012 [Ø0.30]	1.1 oz Avg.	0.3 oz Min	-414T4	Ø.012 [Ø0.30]	1.1 oz Avg.	0.3 oz Min
-01S	Ø.018 [Ø0.46]	9.0 oz Avg.	2.0 oz Min	-93S	Ø.018 [Ø0.46]	9.0 oz Avg.	2.0 oz Min

MOUNTING OPTIONS

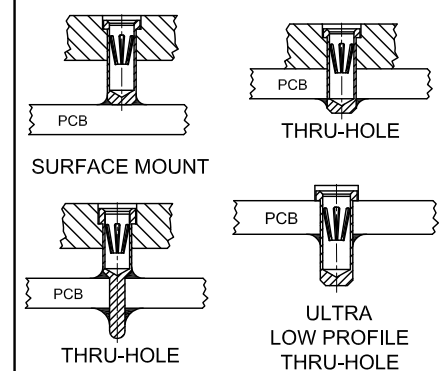

©Copyright 2015 Andon Electronics Corporation. All Rights Reserved. This material is protected under US and other copyrights and may not be copied, sold, or redistributed in any form without written permission of Andon Electronics Corporation. Copyrights and trademarks are property of their respective companies. We reserve the right to change specifications without notice. Andon makes no warranty, expressed or implied, as to the suitability of the sockets for the intended purpose.

"ANDON PROPRIETARY INFORMATION"
RoHS Compliant

*Sockets are not drawn to scale MDX 8/20/2015

ANDON ELECTRONICS CORPORATION
4 Court Drive, Lincoln RI 02865, United States of America

www.andonelectronics.com or www.andonelect.com
Phone 401-333-0388 Fax 401-333-0287
Email Info@andonelect.com