

HONG KONG X'TALS LIMITED						
HONG KONG X'TALS LIMITED Model Number	Andon Part Number Replace "XXX" with Terminal Type	Terminal Type		Pin Ø [in]	Figure Number	Page Number
		Thru-Hole	Surface Mount			
HC49U	CSP192-02-01-XXX-R27-L14	01S	93S	.018	1	1
HC49UT	CSP192-02-01-XXX-R27-L14	01S	93S	.018	1	1
HC49US	CSP192-02-01-XXX-R27-L14	01S	93S	.018	1	1
HC49U-9U	CSP192-02-01-XXX-R27-L14	01S	93S	.018	1	1
HC49U-9T	CSP192-02-01-XXX-R27-L14	01S	93S	.018	1	1
HC49U-9D	CSP192-02-01-XXX-R27-L14	01S	93S	.018	1	1
HC49U-6A	CSP192-02-01-XXX-R27-L14	01S	93S	.018	1	1
HC49UT-9U	CSP192-02-01-XXX-R27-L14	01S	93S	.018	1	1
HC49UT-9T	CSP192-02-01-XXX-R27-L14	01S	93S	.018	1	1
HC49UT-9D	CSP192-02-01-XXX-R27-L14	01S	93S	.018	1	1
HC49UT-6A	CSP192-02-01-XXX-R27-L14	01S	93S	.018	1	1
UM-1U	CSP148-02-02-XXX-R27-L14	01S	93S	.018	2	1
UM-5U	CSP148-02-02-XXX-R27-L14	01S	93S	.018	2	1
PE	R197-SP02-01-XXX-R27-L14	01S	93S	.018	5	2
HC49US-93	CSP192-03-01-XXX-R27-L14	01S	93S	.018	10	2
HC49US-9S	CSP192-03-01-XXX-R27-L14	01S	93S	.018	10	2
HC49US-94	CSP192-03-01-XXX-R27-L14	01S	93S	.018	10	2
HC49US-95	CSP192-03-01-XXX-R27-L14	01S	93S	.018	10	2
HC49US-B3	CSP192-03-01-XXX-R27-L14	01S	93S	.018	10	2
HC49US-BS	CSP192-03-01-XXX-R27-L14	01S	93S	.018	10	2
HC49US-B4	CSP192-03-01-XXX-R27-L14	01S	93S	.018	10	2
Q3	606D-07-SM-G10-L14-X	-	-	-	13	4
Q7	606D-07-SM-G10-L14-X	-	-	-	13	4
CH	C10-308-04-03-XXX-R27-L14	01S	93S	.018	9	3
CF	C10-314-04-01-XXX-R27-L14	01S	93S	.018	4	2
DTCXO-TR	620D-14-SM-G10-L14-X	-	-	-	11	3
QCC570	605D-06B-SM-G10-L14-X	-	-	-	12	3
LVPECL	605D-06B-SM-G10-L14-X	-	-	-	12	3
LVDS	605D-06B-SM-G10-L14-X	-	-	-	12	3
7050 OSCOLLATOR	606D-04A-SM-G10-L14-X	-	-	-	14	4
Q6	C10-1014-05-02-XXX-R27-L14	295V	439V	.030	6	2
Q5	C10-716-05-01-XXX-R27-L14	295V	439V	.030	8	2
Q1	C10-314-04-01-XXX-R27-L14	01S	93S	.018	4	2
Q2	C10-614-05-01-XXX-R27-L14	01S	93S	.018	7	2
Q4	C10-7524-04-01-XXX-R27-L14	01S	93S	.018	3	2

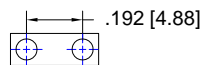

Fig. 1
Thru-Hole: CSP192-02-01-01S-R27-L14
Surface Mount: CSP192-02-01-93S-R27-L14

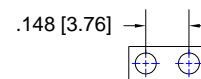

Fig. 2
Thru-Hole: CSP148-02-02-01S-R27-L14
Surface Mount: CSP148-02-02-93S-R27-L14

HONG KONG X'TALS LIMITED *Continued*

Socket Terminal Details

Cross Section View Shown Units: in [mm]

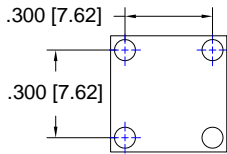

Fig. 3

Thru-Hole: C10-7524-04-01-01S-R27-L14
Surface Mount: C10-7524-04-01-93S-R27-L14

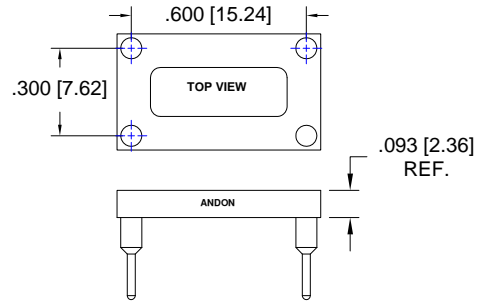

Fig. 4

Thru-Hole: C10-314-04-01-01S-R27-L14
Surface Mount: C10-314-04-01-93S-R27-L14

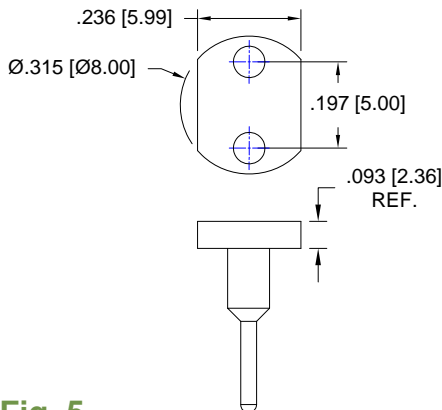

Fig. 5

Thru-Hole: R197-SP02-01-01S-R27-L14
Surface Mount: R197-SP02-01-93S-R27-L14

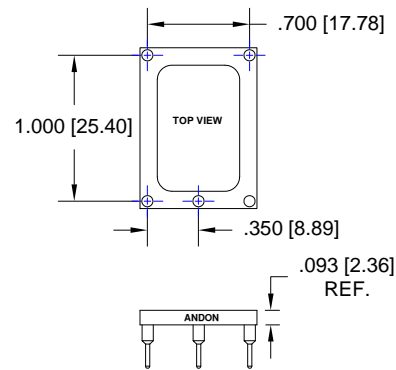

Fig. 6

Thru-Hole: C10-1014-05-02-295V-R27-L14
Surface Mount: C10-1014-05-02-439V-R27-L14

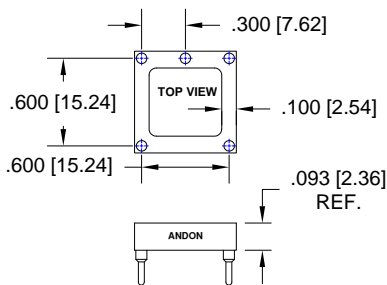

Fig. 7

Thru-Hole: C10-614-05-01-01S-R27-L14
Surface Mount: C10-614-05-01-93S-R27-L14

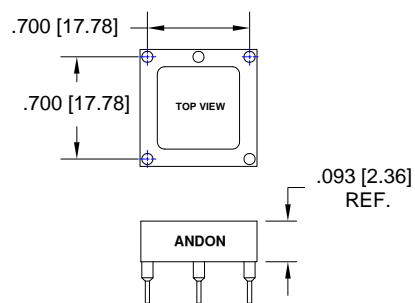

Fig. 8

Thru-Hole: C10-716-05-01-295V-R27-L14
Surface Mount: C10-716-05-01-439V-R27-L14

HONG KONG X'TALS LIMITED *Continued*

Socket Terminal Details

Cross Section View Shown Units: in [mm]

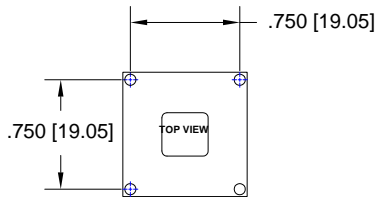

Fig. 9

Thru-Hole: C10-308-04-03-01S-R27-L14
Surface Mount: C10-308-04-03-93S-R27-L14

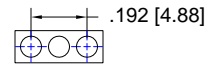

Fig. 10

Thru-Hole: CSP192-03-01-01S-R27-L14
Surface Mount: CSP192-03-01-93S-R27-L14

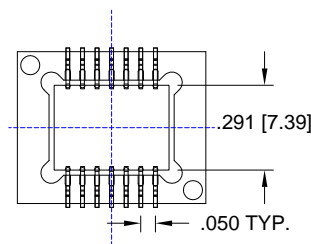

Fig. 11

Thru-Hole: N/A
Surface Mount: 620D-14-SM-G10-L14-X

WITHOUT INDEX PINS = -0
WITH INDEX PINS = -1

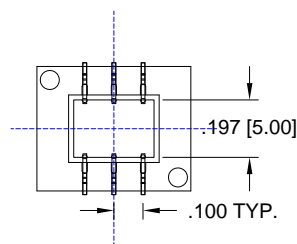
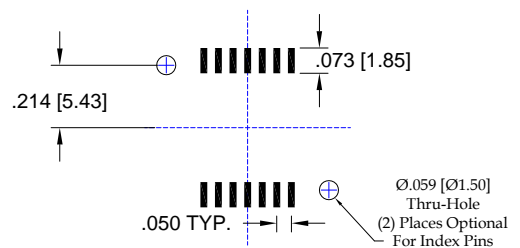
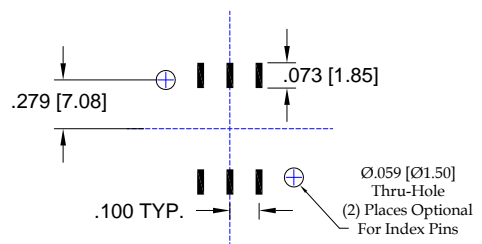

Fig. 12

Thru-Hole: N/A
Surface Mount: 605D-06B-SM-G10-L14-X

WITHOUT INDEX PINS = -0
WITH INDEX PINS = -1



HONG KONG X'TALS LIMITED *Continued*

Socket Terminal Details

Cross Section View Shown Units: in [mm]

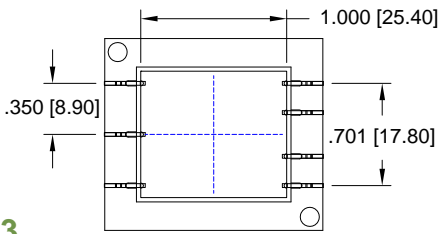

Fig. 13

Thru-Hole: N/A

Surface Mount: 606D-07-SM-G10-L14-X

WITHOUT INDEX PINS = -0
WITH INDEX PINS = -1

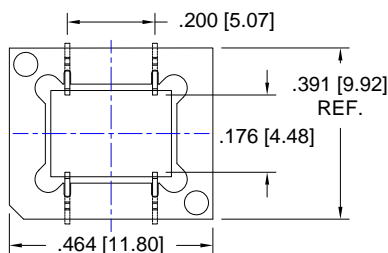
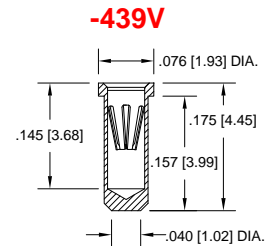
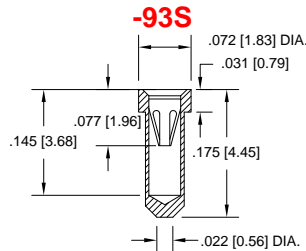
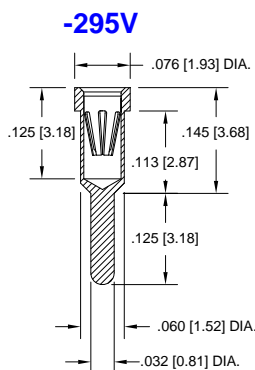
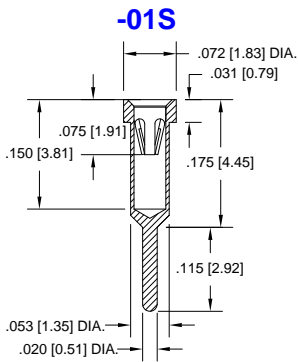
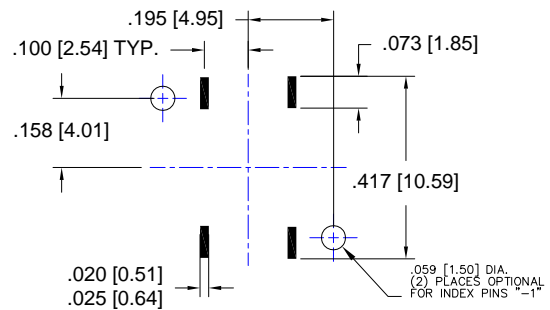
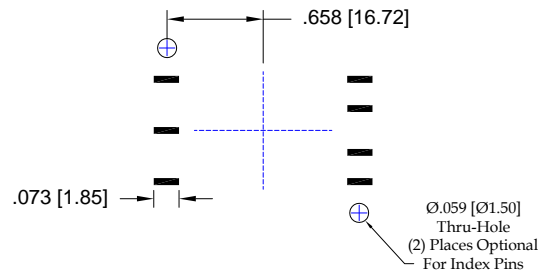

Fig. 14

Thru-Hole: N/A

Surface Mount: 606D-04A-SM-G10-L14-X

WITHOUT INDEX PINS = -0
WITH INDEX PINS = -1



Technical Information

Material:

Insulator: Hi-Temp UL 94V-O
Terminal: Brass, per ASTM-B16
Contact: BeCu, Per ASTM-B194

Plating: RoHS COMPLIANT

R15 TERMINAL: GOLD / CONTACT: GOLD

R17 TERMINAL: TIN / CONTACT: GOLD

OTHER PLATINGS AVAILABLE

Terminal Acceptance and Forces

Thru Hole Terminals				Surface Mount Terminals			
Thru Hole Terminal	Accepts Pin Diameter	Insertion Force	Withdrawal Force	Surface Mount Terminal	Accepts Pin Diameter	Insertion Force	Withdrawal Force
-01S	Ø.018 [Ø0.46]	9.0 oz Avg.	2.0 oz Min	-93S	Ø.018 [Ø0.46]	9.0 oz Avg.	2.0 oz Min
-295V	Ø.030 [Ø.76]	13.2 oz Max	3.5 oz Min	-439V	Ø.030 [Ø.76]	13.2 oz Max	3.5 oz Min

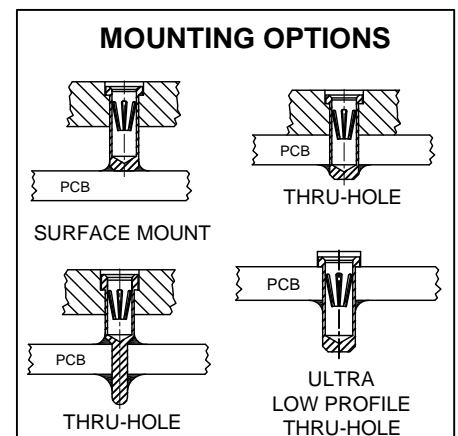

"ANDON PROPRIETARY INFORMATION"

RoHS Compliant

©Copyright 2014 Andon Electronics Corporation. All Rights Reserved. This material is protected under US and other copyrights and may not be copied, sold, or redistributed in any form without written permission of Andon Electronics Corporation. Copyrights and trademarks are property of their respective companies. We reserve the right to change specifications without notice. Andon makes no warranty, expressed or implied, as to the suitability of the sockets for the intended purpose.

*Sockets are not drawn to scale HONG KONG X'TALS LIMITED 12/16/2014