



ANDON
INTERCONNECTION SPECIALISTS



RoHS Compliant
ISO 9001
Certified

HIGH RELIABILITY CRYSTALS SOCKETS FOR

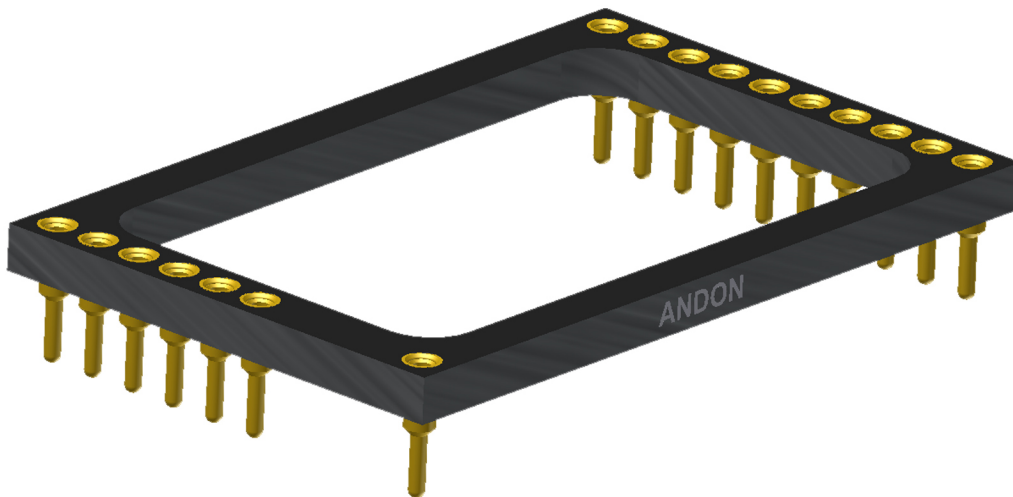

Featuring Andon's Unique Senstac™ Contact

GREENRAY INDUSTRIES, INC. is a trade mark of GREENRAY INDUSTRIES, INC.

GREENRAY INDUSTRIES, INC.						
GREENRAY INDUSTRIES, INC. Model Number	Andon Part Number Replace "XXX" with Terminal Type	Terminal Type		Pin Ø [in]	Figure Number	Page Number
		Thru-Hole	Surface Mount			
ZT620 TO ZT623 SERIES	C10-314-14-01-XXX-R27-L14	01S	93S	.018	1	1
T1220 SERIES	C10-314-04-01-XXX-R27-L14	01S	93S	.018	2	1
T1300 SERIES	C10-314-14-01-XXX-R27-L14	01S	93S	.018	1	1
T1170/1171 SERIES	C10-608-05-02-XXX-R27-L14	01S	93S	.018	3	1
ZT560 SERIES	C10-314-04-01-XXX-R27-L14	01S	93S	.018	2	1

Heat sink socket available to reduce heat and noise. Contact Andon for details.

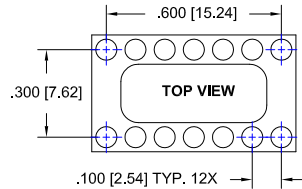

FIG.1

Thru-Hole: C10-314-14-01-01S-R27-L14
Surface Mount: C10-314-14-01-93S-R27-L14

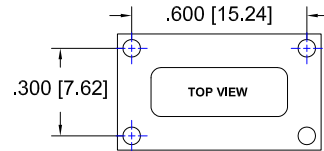

Fig.2

Thru-Hole: C10-314-04-01-01S-R27-L14
Surface Mount: C10-314-04-01-93S-R27-L14

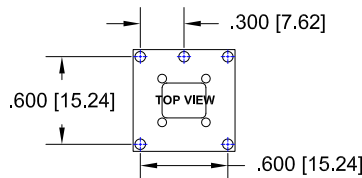
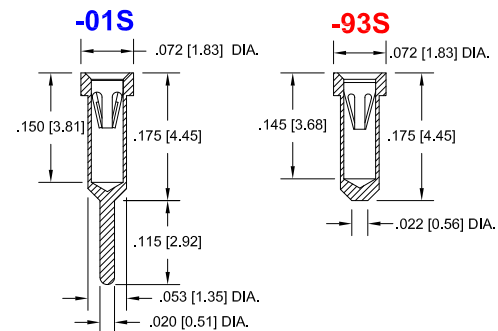

Fig.3

Thru-Hole: C10-608-05-02-01S-R27-L14
Surface Mount: C10-608-05-02-93S-R27-L14

Socket Terminal Details

Cross Section View Shown Units: in [mm]



Technical Information

Material:

Insulator: Hi-Temp UL 94V-O
Terminal: Brass, per ASTM-B16
Contact: BeCu, Per ASTM-B194

Plating: RoHS COMPLIANT

R27 TERMINAL: GOLD / CONTACT: GOLD

R17 TERMINAL: TIN / CONTACT: GOLD

OTHER PLATINGS AVAILABLE

Terminal Acceptance and Forces							
Thru Hole Terminals				Surface Mount Terminals			
Thru Hole Terminal	Accepts Pin Diameter	Insertion Force	Withdrawal Force	Surface Mount Terminal	Accepts Pin Diameter	Insertion Force	Withdrawal Force
-01S	Ø.018 [Ø.46]	9.0 oz Avg.	2.0 oz Min	-93S	Ø.018 [Ø.46]	9.0 oz Avg.	2.0 oz Min

MOUNTING OPTIONS

