

Measurement Specialties Pressure Transducers Sensor Sockets						
Meas. Specialties Pressure Transducers Sensors Model Number	Andon Part Number Replace "XXX" with Terminal Type	Terminal Type		Pin Ø [in]	Figure Number	Page Number
		Thru-Hole	Surface Mount			
50	R200-0404-01T-XXX-R27-L14	01S	93S	.018	62B	1
4415	(2) 405-03-XXX-R27-L14	01S	93S	.018	S01	2
4416	(2) 405-03-XXX-R27-L14	01S	93S	.018	S01	2
4425	(2) 405-03-XXX-R27-L14	01S	93S	.018	S01	2
4426	(2) 405-03-XXX-R27-L14	01S	93S	.018	S01	2
13 1psi	R400-SP08-02T-XXX-R27-L14	75S	265S	.018	163	2
23 1psi	R400-SP08-02T-XXX-R27-L14	75S	265S	.018	163	2
33 1psi	R400-SP08-02T-XXX-R27-L14	75S	265S	.018	163	2
43 1psi	R400-SP08-02T-XXX-R27-L14	75S	265S	.018	163	2
1210 1psi	(2) 405-04-XXX-R27-L14	01S	93S	.018	S02	2
13 Std	R400-SP08-02T-XXX-R27-L14	75S	265S	.018	163	2
23 Std	R400-SP08-02T-XXX-R27-L14	75S	265S	.018	163	2
33 Std	R400-SP08-02T-XXX-R27-L14	75S	265S	.018	163	2
43 Std	R400-SP08-02T-XXX-R27-L14	75S	265S	.018	163	2
1210 Std	(2) 405-04-XXX-R27-L14	01S	93S	.018	S02	2
1220 Std	(2) 405-04-XXX-R27-L14	01S	93S	.018	S02	2
1210 Sub psi	(2) 405-04-XXX-R27-L14	01S	93S	.018	S02	2
17 US	R400-SP08-02T-XXX-R27-L14	75S	265S	.018	163	2
47 US	R400-SP08-02T-XXX-R27-L14	75S	265S	.018	163	2
1230 US	(2) 405-04-XXX-R27-L14	01S	93S	.018	S02	2
TCS208F	R280-0808-01T-XXX-R27-L14	01S	93S	.018	115	1
TS105-1	R200-0404-01T-XXX-R27-L14	01S	93S	.018	62B	1
TS105-3	R200-0404-01T-XXX-R27-L14	01S	93S	.018	62B	1
TS105-4	R200-0404-01T-XXX-R27-L14	01S	93S	.018	62B	1
TS105-6	R200-0404-01T-XXX-R27-L14	01S	93S	.018	62B	1
TS105-8	R200-1008-03T-XXX-R27-L14	274K	281K	.018	74	1
TS105-10	R200-0404-01T-XXX-R27-L14	01S	93S	.018	62B	1

Top View Shown

Units: in [mm]

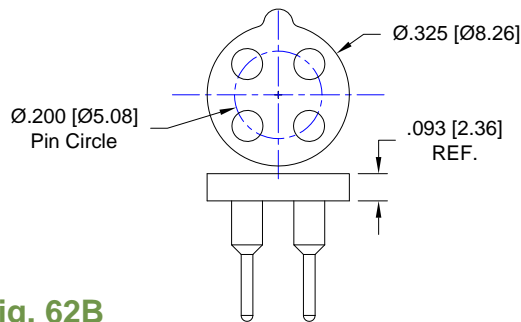

Fig. 62B

Thru-hole: R200-0404-01T-**01S**-R27-L14
Surface Mount: R200-0404-01T-**93S**-R27-L14

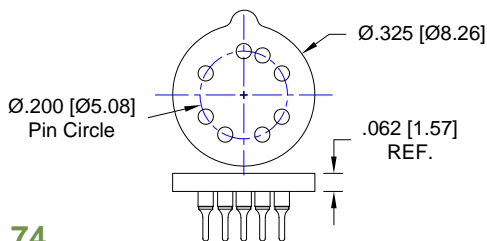

Fig. 74

Thru-hole: R200-1008-03T-**274K**-R27-L14
Surface Mount: R200-1008-03T-**281K**-R27-L14

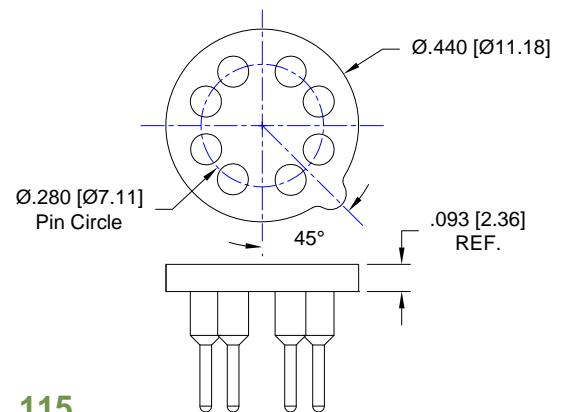
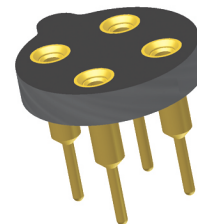

Fig. 115

Thru-Hole: R280-0808-01T-**01S**-R27-L14
Surface Mount: R280-0808-01T-**93S**-R27-L14

Measurement Specialties Pressure Transducers Sensor Sockets *Continued*

Top View Shown

Units: in [mm]

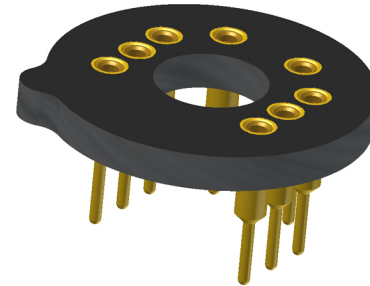
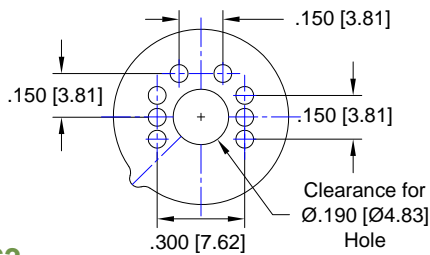

Fig. 163

Thru-Hole: R400-SP08-02T-**75S**-R27-L14

Surface Mount: R400-SP08-02T-**265S**-R27-L14

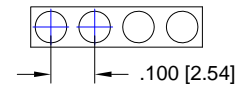
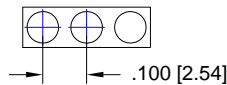

Fig. S01

Thru-hole: (2) 405-03-**01S**-R27-L14

Surface Mount: (2) 405-03-**93S**-R27-L14

Fig. S02

Thru-hole: (2) 405-04-**01S**-R27-L14

Surface Mount: (2) 405-04-**93S**-R27-L14

Socket Terminal Details

Cross Section View Shown Units: in [mm]

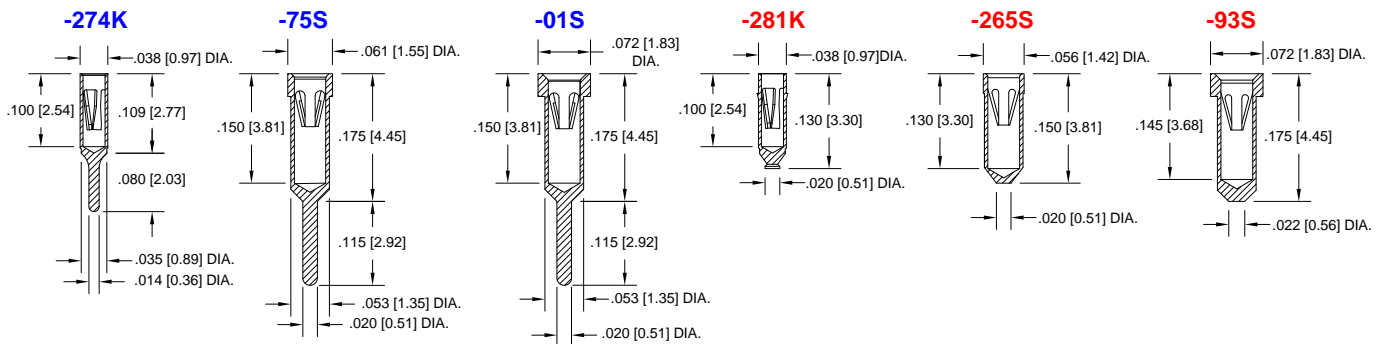

Technical Information

Material:

Insulator: Hi-Temp UL 94V-O
Terminal: Brass, per ASTM-B16
Contact: BeCu, Per ASTM-B194

Plating: RoHS COMPLIANT

R27 TERMINAL: GOLD / CONTACT: GOLD

R17 TERMINAL: TIN / CONTACT: GOLD

OTHER PLATINGS AVAILABLE

Terminal Acceptance and Forces

Thru Hole Terminals				Surface Mount Terminals			
Thru Hole Terminal	Accepts Pin Diameter	Insertion Force	Withdrawal Force	Surface Mount Terminal	Accepts Pin Diameter	Insertion Force	Withdrawal Force
-274K	Ø.018 [Ø0.46]	1.0 oz Max	0.5 oz Min	-281K	Ø.018 [Ø0.46]	1.0 oz Max.	0.5 oz Min
-75S	Ø.018 [Ø0.46]	9.0 oz Avg.	2.0 oz Min	-265S	Ø.018 [Ø0.46]	9.0 oz Avg.	2.0 oz Min
-01S	Ø.018 [Ø0.46]	9.0 oz Avg.	2.0 oz Min	-93S	Ø.018 [Ø0.46]	9.0 oz Avg.	2.0 oz Min

MOUNTING OPTIONS

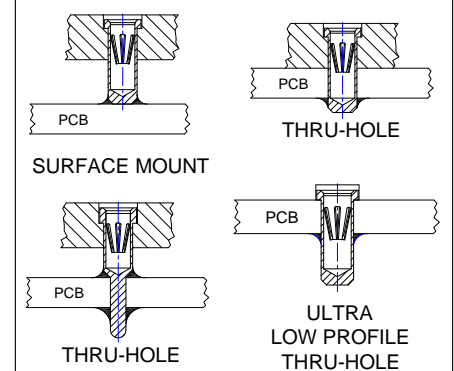

"ANDON PROPRIETARY INFORMATION"

RoHS Compliant

©Copyright 2011 Andon Electronics Corporation. All Rights Reserved. This material is protected under US and other copyrights and may not be copied, sold, or redistributed in any form without written permission of Andon Electronics Corporation. Copyrights and trademarks are property of their respective companies. We reserve the right to change specifications without notice. Andon makes no warranty, expressed or implied, as to the suitability of the sockets for the intended purpose.

*Sockets are not drawn to scale MEASUREMENT SPECIALTIES. 04/12/2011

ANDON ELECTRONICS CORPORATION
4 Court Drive, Lincoln RI 02865, United States of America

www.andonelectronics.com or www.andonelect.com

Phone 401-333-0388 Fax 401-333-0287

Email Info@andonelect.com