



RoHS Compliant
ISO 9001
Certified

OPTOELECTRONIC SOCKETS FOR



***Largest Line of High Reliability Sensor Sockets
with Andon's Unique Senstac™ Contact***

www.andonelect.com or www.andonelectronics.com

Frankfurt Laser Company Copyright© of



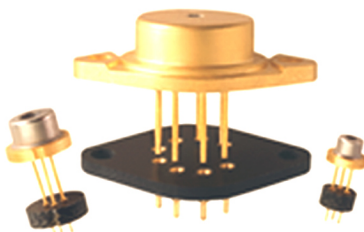

Optoelectronic Sockets

High reliability sockets that will cost effectively:

*Protect
Test
Assemble
and*

Enable Replacing of Opto Devices

- Solder sockets on the PCB
- Plug-in sensors after assembly
- Eliminate ESD from handling
- Eliminate damage from soldering temperatures
- Eliminate damage from cleaning solvents
- Avoid cracking the glass seal
- Reduce shock damage to wire bonds

Customers will appreciate knowing that there are ANDON sockets available

Producers of optoelectronic devices may list ANDON on their engineering drawings and website to assist their customers in design engineering.

Distributors have an opportunity to increase their revenue by selling ANDON sockets with the sales of their optoelectronic devices.

Frankfurt Laser Co. Sockets						
Frankfurt Laser Co. Model Number	Andon Part Number Replace "XXX" with Terminal Type	Terminal Type		Pin Ø [in]	Figure Number	Page Number
		Thru-Hole	Surface Mount			
FAXD-5.6mm Package	R080-0403-01N-XXX-R27-L14	274K	281K	.018	12	3
FAXD-9mm Package	R100-0403-04N-XXX-R27-L14	75S	265S	.018	14	3
FAXD-HHL Package	C10-010-09-01-XXX-R27-L14	433E	285E	.040	10	3
FBLD-BTF Package	(2) C10-007-07-01-XXX-R27-L14	01S	93S	.018	5	2
FBLD-DF-FS-10Pin Package	C10-005-05-01-XXX-R27-L14	295V	439V	.030	3	2
FBLD-DF-FS-HHL14 Package	(2) C10-007-07-01-XXX-R27-L14	295V	439V	.030	6	2
FBLD-DF-HHL9 Package	C10-010-09-01-XXX-R27-L14	295V	439V	.030	9	3
FBLD-DF-HHL14 Package	(2) C10-007-07-01-XXX-R27-L14	295V	439V	.030	6	2
FBLD-FC-2Pin-A1 Package	C10-002-02-01-XXX-R27-L14	433E	285E	.040	2	2
FBLD-FC-5Pin Package	C10-005-05-01-XXX-R27-L14	295V	439V	.030	3	2
FBLD-FC-6Pin Package	409-203-XXX-R27-L14	01S	93S	.018	1	1
FBLD-FC-Coax-56mm Package	R080-0403-01N-XXX-R27-L14	274K	281K	.018	12	3
FBLD-FC-Coax-9mm Package	R100-0403-04N-XXX-R27-L14	75S	265S	.018	14	3
FBLD-FC-HHL9 Package	C10-010-09-01-XXX-R27-L14	295V	439V	.030	9	3
FBLD-FC-HHL15 Sip1 Package	C10-008-07-01-XXX-R27-L14	295V	439V	.030	7	2
FBLD-FC-HHL15 Sip2 Package	C10-008-08-01-XXX-R27-L14	295V	439V	.030	8	2
FBLD-TO Flange Package	R100-0403-04N-XXX-R27-L14	75S	265S	.018	14	3
FBLD-WI-HHL9 Package	C10-010-09-01-XXX-R27-L14	295V	439V	.030	9	3
FLX-9mm Package	R100-0403-04N-XXX-R27-L14	75S	265S	.018	14	3
FLX-HHL Package	C10-010-09-01-XXX-R27-L14	433E	285E	.040	10	3
FLX-TO 3 Package	F500-SP09-01-XXX-R27-L14	433E	285E	.040	22	5
FNPL-5.6mm Package	R080-0403-01N-XXX-R27-L14	274K	281K	.018	12	3
FNPL-9mm Package	R100-0403-04N-XXX-R27-L14	75S	265S	.018	14	5
FNPL-BTF Package	(2) C10-007-07-01-XXX-R27-L14	295V	439V	.030	6	2
FNPL-TO 5 Package	R200-0808-01T-XXX-R27-L14	75S	265S	.018	16	4
FNPL-TO 8 Package	R375-SP06-02T-XXX-R27-L14	75S	265S	.018	20	4
FSLD-Butterfly Package	(2) C10-007-07-01-XXX-R27-L14	274K	281K	.018	4	2
FSLD-DIL14 Package	C10-314-14-01-XXX-R27-L14	01S	93S	.018	11	3
FSLD-SOT148 Package	R100-0403-04N-XXX-R27-L14	75S	265S	.018	14	3
FSLD-TO3-1 Package	R350-SP08-01-XXX-R27-L14	01S	93S	.018	18	4
FSLD-TO3-2 Package	F350-SP08-01-XXX-R27-L14	01S	93S	.018	21	5
TO-8 Package	R375-SP06-02T-XXX-R27-L14	75S	265S	.018	19	4
TO-18 Package	R100-0402-03T-XXX-R27-L14	75S	265S	.018	13	3
TYPE "C" Package	R256-SP04-01T-XXX-R27-L14	01S	93S	.018	17	4
TYPE "D" (TO-3) Package	F500-SP09-01-XXX-R27-L14	433E	285E	.040	22	5
TYPE "G" (SOT-148) Package	R100-0403-04N-XXX-R27-L14	75S	265S	.018	14	3
TYPE "GR" Package	R100-0404-03N-XXX-R27-L14	211S	384S	.018	15	3
TYPE "M8" Package	R375-SP16-01T-XXX-R27-L14	75S	265S	.018	20	4
TYPE "MG" Package	R080-0403-01N-XXX-R27-L14	274K	281K	.018	12	3
TYPE "N" Package	R100-0403-04N-XXX-R27-L14	75S	265S	.018	14	3

Top View Shown
Units: in [mm]

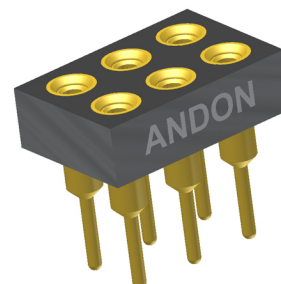
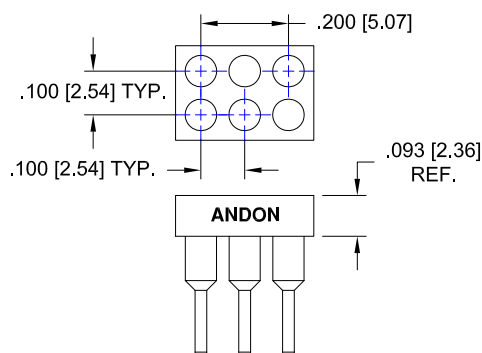

Fig. 1

Thru-Hole: 409-203-01S-R27-L14

Surface Mount: 409-203-93S-R27-L14

©Copyright 2012 Andon Electronics Corporation. All Rights Reserved. This material is protected under US and other copyrights and may not be copied, sold, or redistributed in any form without written permission of Andon Electronics Corporation. Copyrights and trademarks are property of their respective companies. We reserve the right to change specifications without notice. Andon makes no warranty, expressed or implied, as to the suitability of the sockets for the intended purpose.

"ANDON PROPRIETARY INFORMATION"
RoHS Compliant

*Sockets are not drawn to scale Frankfurt Laser Co. 01/28/2013

ANDON ELECTRONICS CORPORATION
4 Court Drive, Lincoln RI 02865, United States of America

www.andonelectronics.com or www.andonelect.com
Phone 401-333-0388 Fax 401-333-0287
Email Info@andonelect.com

Frankfurt Laser Co. Continued

Top View Shown

Units: in [mm]

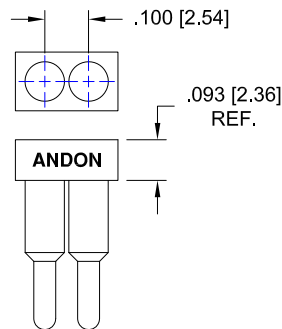

Fig. 2

Thru-Hole: C10-002-02-01-433E-R27-L14

Surface Mount: C10-002-02-01-285E-R27-L14

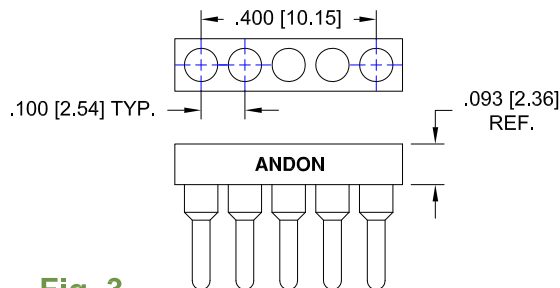

Fig. 3

Thru-Hole: C10-005-05-01-295V-R27-L14

Surface Mount: C10-005-05-01-439V-R27-L14

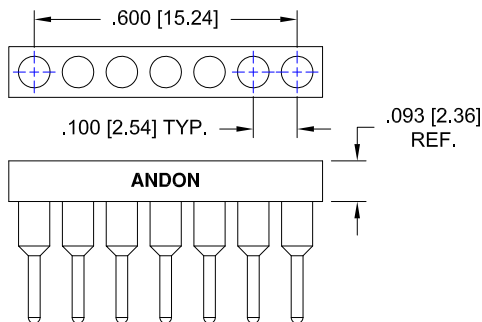

Fig. 5

2 SIPS REQUIRED

Thru-Hole: (2) C10-007-07-01-01S-R27-L14

Surface Mount: (2) C10-007-07-01-93S-R27-L14

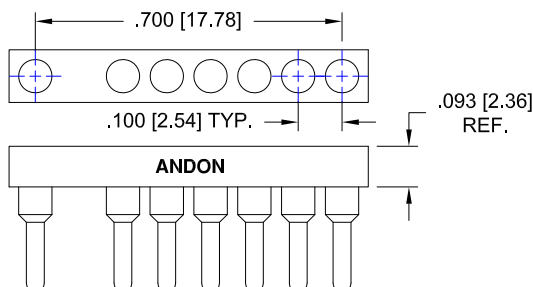

Fig. 7

Thru-Hole: C10-008-07-01-295V-R27-L14

Surface Mount: C10-008-07-01-439V-R27-L14

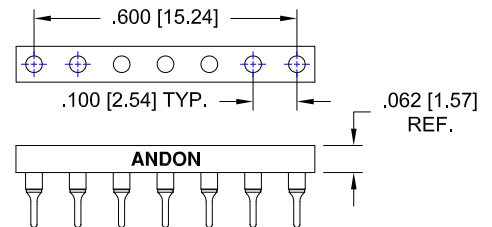
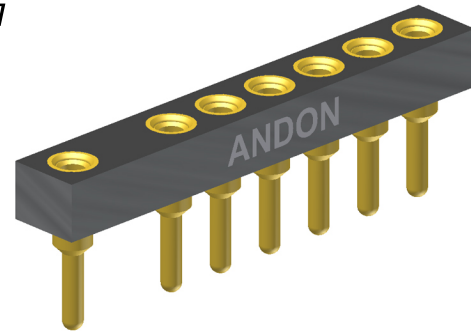

Fig. 4

2 SIPS REQUIRED

Thru-Hole: (2) C10-007-07-01-274K-R27-L14

Surface Mount: (2) C10-007-07-01-281K-R27-L14

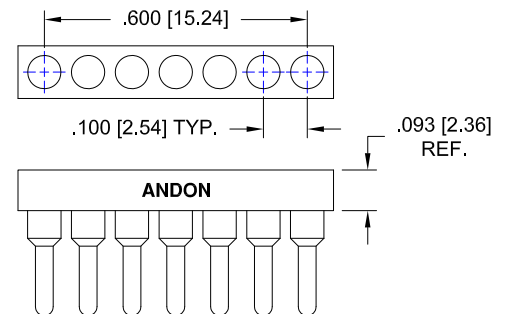

Fig. 6

Thru-Hole: (2) C10-007-07-01-295V-R27-L14

Surface Mount: (2) C10-007-07-01-439V-R27-L14

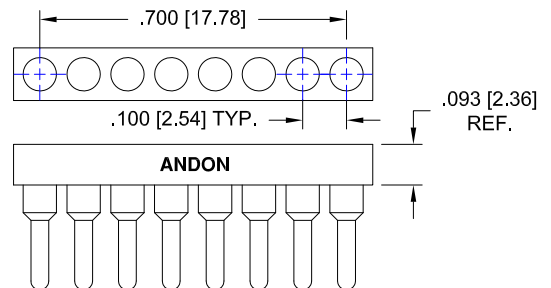

Fig. 8

Thru-Hole: C10-008-08-01-295V-R27-L14

Surface Mount: C10-008-08-01-439V-R27-L14

Frankfurt Laser Co. Continued

Top View Shown

Units: in [mm]

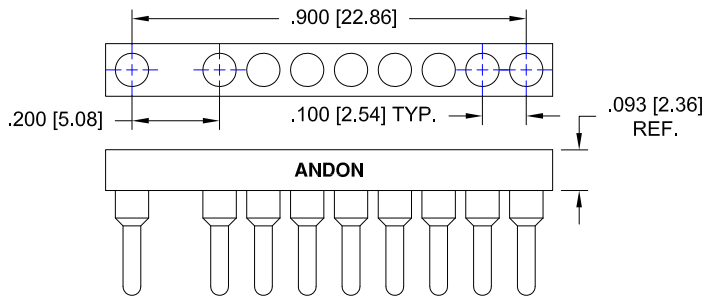

Fig. 9

Thru-Hole: C10-010-09-01-**295V**-R27-L14

Surface Mount: C10-010-09-01-**439V**-R27-L14

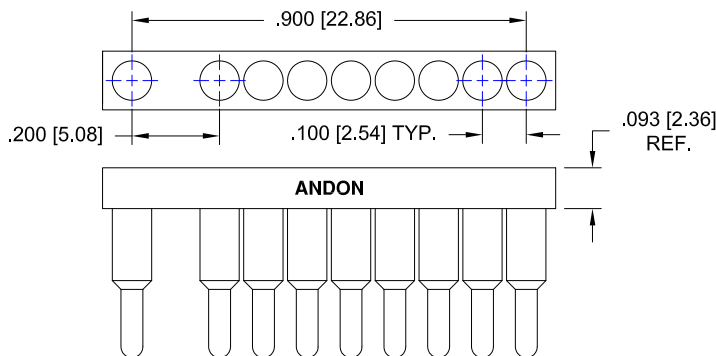

Fig. 10

Thru-Hole: C10-010-09-01-**433E**-R27-L14

Surface Mount: C10-010-09-01-**285E**-R27-L14

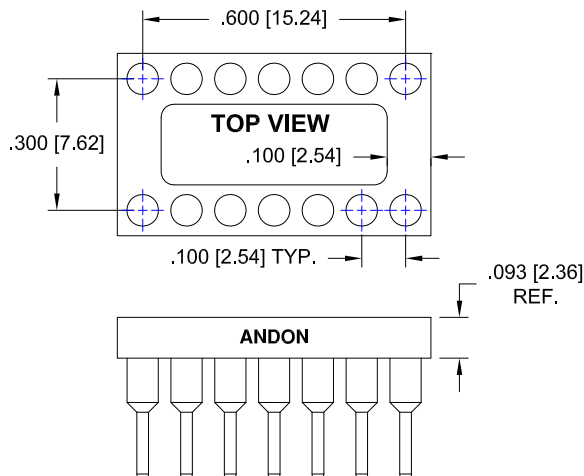

Fig. 11

Thru-Hole: C10-314-14-01-**01S**-R27-L14

Surface Mount: C10-314-14-01-**93S**-R27-L14

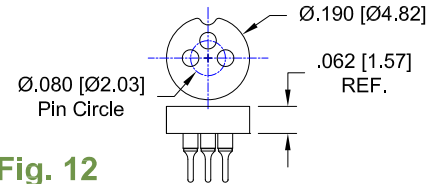
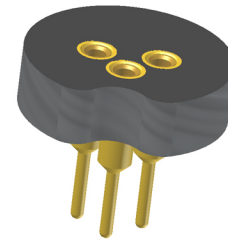

Fig. 12

Thru-Hole: R080-0403-01N-**274K**-R27-L14

Surface Mount: R080-0403-01N-**281K**-R27-L14

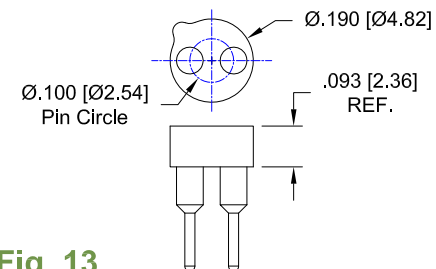

Fig. 13

Thru-Hole: R100-0402-03T-**75S**-R27-L14

Surface Mount: R100-0402-03T-**265S**-R27-L14

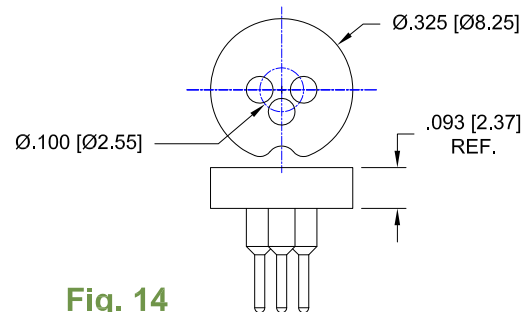

Fig. 14

Thru-Hole: R100-0403-04N-**75S**-R27-L14

Surface Mount: R100-0403-04N-**265S**-R27-L14

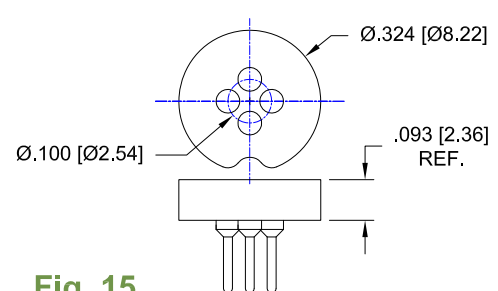

Fig. 15

Thru-Hole: R100-0404-03N-**211S**-R27-L14

Surface Mount: R100-0404-03N-**384S**-R27-L14

Frankfurt Laser Co. Continued

Top View Shown

Units: in [mm]

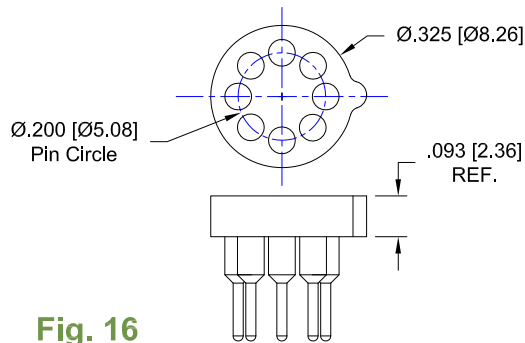

Fig. 16

Thru-Hole: R200-0808-01T-**75S**-R27-L14

Surface Mount: R200-0808-01T-**265S**-R27-L14

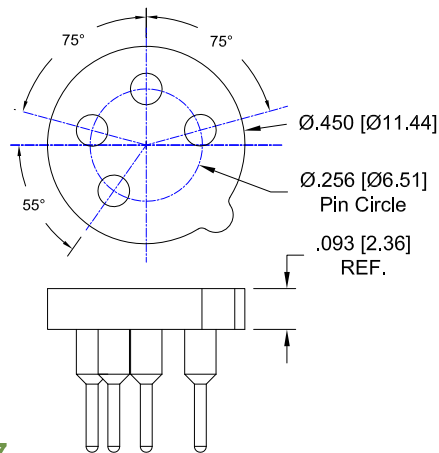
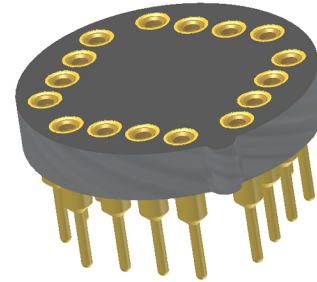

Fig. 17

Thru-Hole: R256-SP04-01T-**01S**-R27-L14

Surface Mount: R256-SP04-01T-**93S**-R27-L14

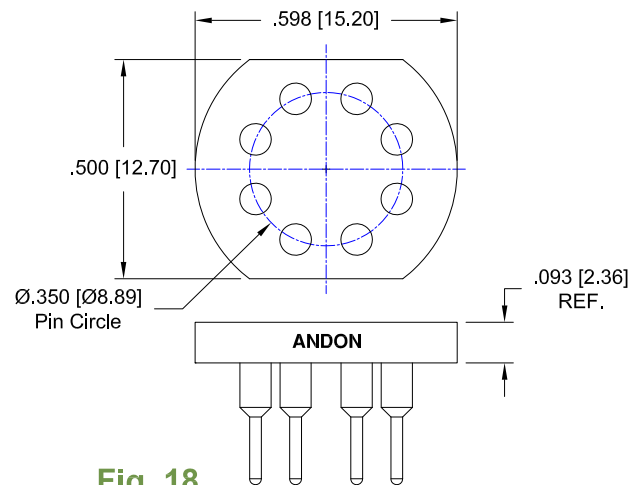

Fig. 18

Thru-Hole: R350-SP08-01-**01S**-R27-L14

Surface Mount: R350-SP08-01-**93S**-R27-L14

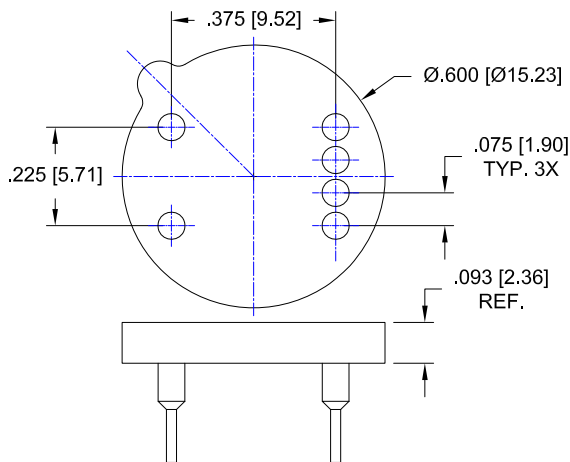

Fig. 19

Thru-Hole: R375-SP06-02T-**75S**-R27-L14

Surface Mount: R375-SP06-02T-**265S**-R27-L14

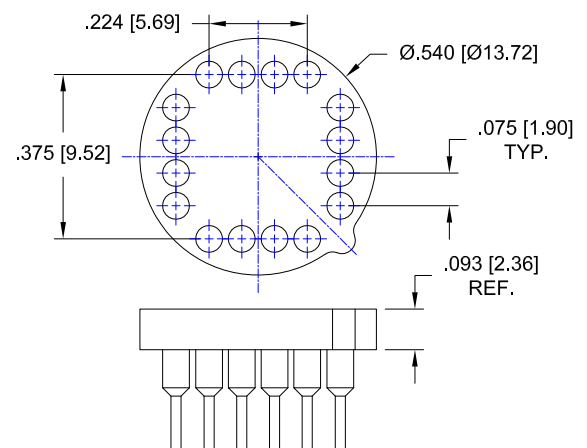

Fig. 20

Thru-Hole: R375-SP16-01T-**75S**-R27-L14

Surface Mount: R375-SP16-01T-**265S**-R27-L14

Frankfurt Laser Co. Continued

Top View Shown

Units: in [mm]

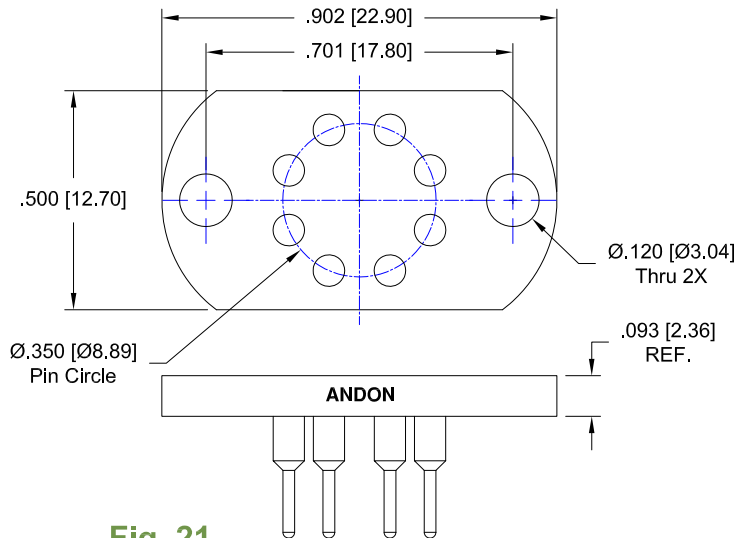

Fig. 21

Thru-Hole: F350-SP08-01-01S-R27-L14

Surface Mount: F350-SP08-01-93S-R27-L14

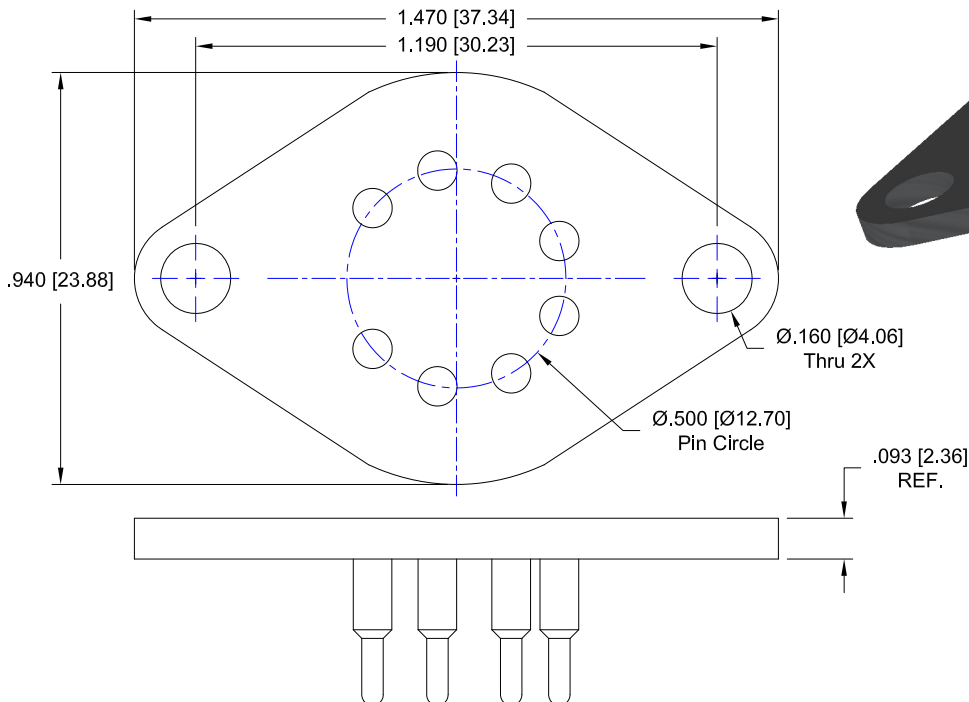
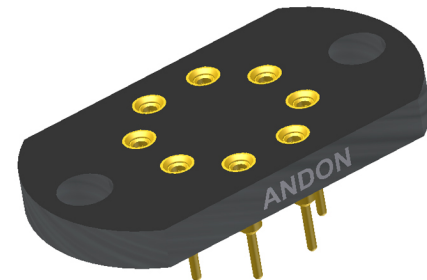
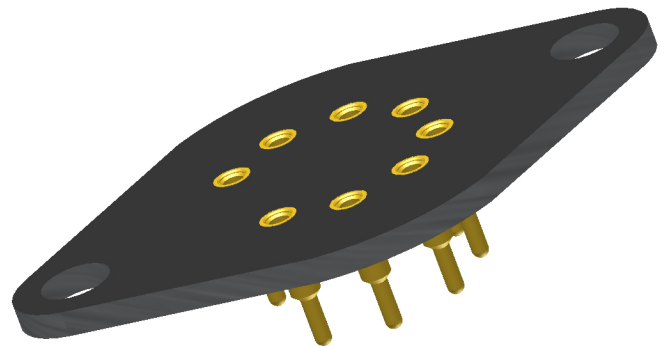

Fig. 22

Thru-Hole: F500-SP09-01-433E-R27-L14

Surface Mount: F500-SP09-01-285E-R27-L14



Frankfurt Laser Co. Continued

Socket Terminal Details Cross Section View Shown Units: in [mm]

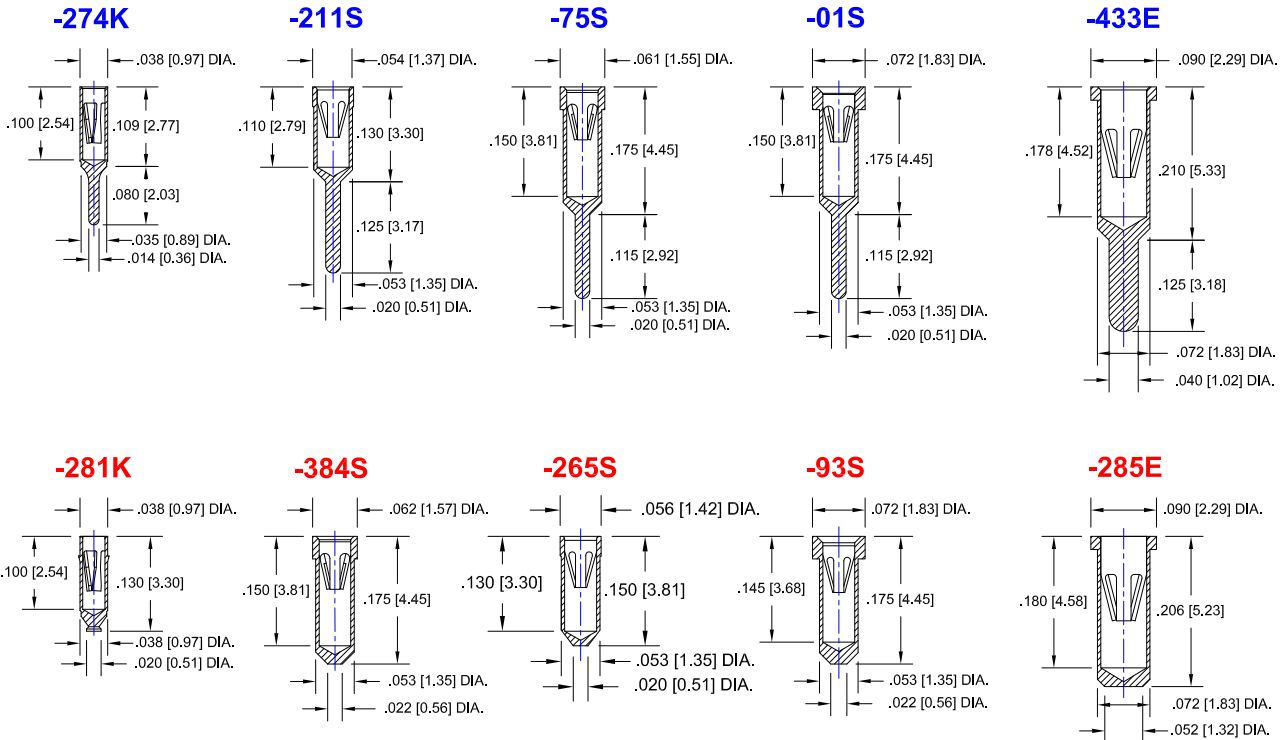

Material:

Insulator: Hi-Temp UL 94V-O
 Terminal: Brass, per ASTM-B16
 Contact: BeCu, Per ASTM-B194

Plating: RoHS COMPLIANT

R27 TERMINAL: GOLD / CONTACT: GOLD

R17 TERMINAL: TIN / CONTACT: GOLD

OTHER PLATINGS AVAILABLE

Terminal Acceptance and Forces							
Thru Hole Terminals				Surface Mount Terminals			
Thru Hole Terminal	Accepts Pin Diameter	Insertion Force	Withdrawal Force	Surface Mount Terminal	Accepts Pin Diameter	Insertion Force	Withdrawal Force
-274K	Ø.018 [Ø0.46]	1.0 oz Max	0.5 oz Min	-281K	Ø.018 [Ø0.46]	1.0 oz Max	0.5 oz Min
-211S	Ø.018 [Ø0.46]	9.0 oz Avg.	2.0 oz Min	-384S	Ø.018 [Ø0.46]	9.0 oz Avg.	2.0 oz Min
-75S	Ø.018 [Ø0.46]	9.0 oz Avg.	2.0 oz Min	-265S	Ø.018 [Ø0.46]	9.0 oz Avg.	2.0 oz Min
-01S	Ø.018 [Ø0.46]	9.0 oz Avg.	2.0 oz Min	-93S	Ø.018 [Ø0.46]	9.0 oz Avg.	2.0 oz Min
-433E	Ø.040 [Ø1.02]	36.0 oz Max	3.9 oz Min	-285E	Ø.040 [Ø1.02]	36.0 oz Max	3.9 oz Min

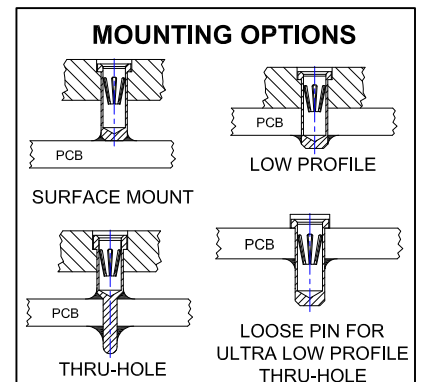

At Andon Electronics we provide interconnection components that help companies to cost effectively protect, assemble, test and replace their semiconductor devices.



- PGA SOCKETS & ADAPTERS
- BGA SOCKETS & ADAPTERS
- SMD SOCKETS & ADAPTERS
- DIP SOCKETS & ADAPTERS
- SIP SOCKETS & ADAPTERS
- FUSE SOCKETS
- TERMINALS AND TEST JACKS
- LCC SOCKETS
- PLCC SOCKETS
- IMAGE SENSOR SOCKETS
- GAS SENSOR SOCKETS
- OPTOELECTRONIC SOCKETS
- CARRIER SOCKETS
- BATTERY SOCKETS
- TEST SOCKETS

We offer custom as well as our standard catalog items.

Our intention is to be your one stop for all of your interconnection requirements.

Please visit our website at www.andonelect.com if you have any questions please do not hesitate to contact us.

Contact: Customer Service

Phone: (401) 333-0388

Fax: (401) 333-0287

Email: info@andonelect.com



Distributed Worldwide.



ANDON ELECTRONICS CORPORATION

4 Court Drive Lincoln, RI 02865 USA

Phone: 401-333-0388 Fax: 401-333-0287

Email: Info@andonelect.com

Visit us on the Web at www.andonelect.com
or www.andonelectronics.com