

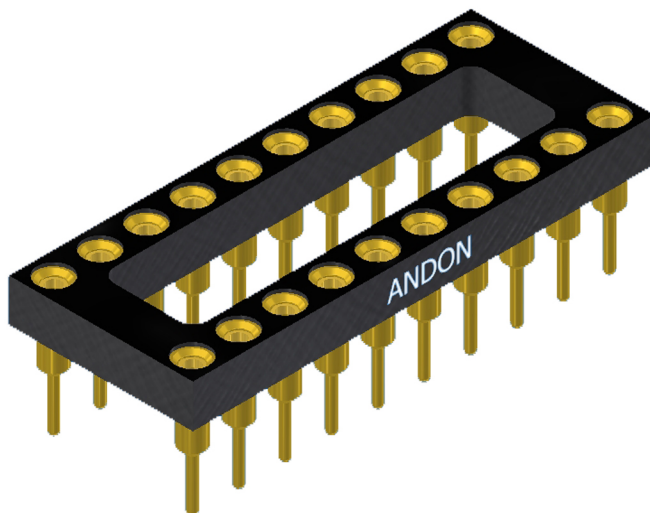

RoHS Compliant
ISO 9001
Certified

**HIGH RELIABILITY
OPTOELECTRONIC SOCKETS FOR
EVERLIGHT**

EVERLIGHT®



Featuring Andon's Unique Senstac™ Contact

Everlight® is a trade mark of Everlight Electronics Co., Ltd.

Everlight						
Everlight Model Number	Andon Part Number Replace "XXX" with Terminal Type	Terminal Type		Pin Ø [in]	Figure Number	Page Number
		Thru-Hole	Surface Mount			
4N2-DIP SERIES	C10-306-06-01-XXX-R27-L14	01S	93S	.018	23	7
4N2XSERIES-M	C10-406-06-01-XXX-R27-L14	01S	93S	.018	24	7
4N33S(TA)-V-DIP	C10-306-06-01-XXX-R27-L14	01S	93S	.018	23	7
4N33S(TA)-V-M	C10-406-06-01-XXX-R27-L14	01S	93S	.018	24	7
4N3-DIP SERIES	C10-306-06-01-XXX-R27-L14	01S	93S	.018	23	7
4N3XSERIES-M	C10-406-06-01-XXX-R27-L14	01S	93S	.018	24	7
4N-DIP SERIES	C10-306-06-01-XXX-R27-L14	01S	93S	.018	23	7
4N-MSERIES	C10-406-06-01-XXX-R27-L14	01S	93S	.018	24	7
6N137S(TA)-V-DIP	C10-308-08-01-XXX-R27-L14	01S	93S	.018	6	4
6N137S(TA)-V-M	C10-408-08-01-XXX-R27-L14	01S	93S	.018	5	4
6N137S(TB)-V-DIP	C10-308-08-01-XXX-R27-L14	01S	93S	.018	6	4
6N137S(TB)-V-M	C10-408-08-01-XXX-R27-L14	01S	93S	.018	5	4
6N137S1(TA-V)-DIP	C10-308-08-01-XXX-R27-L14	01S	93S	.018	6	4
6N137S1(TA-V)-M	C10-408-08-01-XXX-R27-L14	01S	93S	.018	5	4
6N138S(TA)-DIP	C10-308-08-01-XXX-R27-L14	01S	93S	.018	6	4
6N139S(TA)-V-DIP	C10-308-08-01-XXX-R27-L14	01S	93S	.018	6	4
6N38S(TA)-M	C10-408-08-01-XXX-R27-L14	01S	93S	.018	5	4
6N39S(TA)-V-M	C10-408-08-01-XXX-R27-L14	01S	93S	.018	5	4
6N39-V-DIP	C10-308-08-01-XXX-R27-L14	01S	93S	.018	6	4
6N39-V-M	C10-408-08-01-XXX-R27-L14	01S	93S	.018	5	4
EAA03BLAGGA0	351-204-XXX-R27-B10	01P28	93P28	.028	12	5
EAA03BLAGYA0	351-204-XXX-R27-B10	01P28	93P28	.028	12	5
EAA03BLARGA0	351-204-XXX-R27-B10	01P28	93P28	.028	12	5
EAA03BLARRA0	351-204-XXX-R27-B10	01P28	93P28	.028	12	5
EAA03BLAYYA0	351-204-XXX-R27-B10	01P28	93P28	.028	12	5
EAA03BLDRGA1	301-003-XXX-R27-B10	01P28	93P28	.028	17	6
EAA03SLBGA3	301-002-XXX-R27-B10	01P28	93P28	.028	11	5
EAA05SLCGA0	301-002-XXX-R27-B10	01P28	93P28	.028	11	5
EAA05SLCRA0	301-002-XXX-R27-B10	01P28	93P28	.028	11	5
EADCD040GA4	CSP492-16-01-XXX-R27-L14	01S	93S	.018	25	8
EADCD040OA1	CSP492-10-01-XXX-R27-L14	01S	93S	.018	27	8
EADCD040OA2	CSP492-10-01-XXX-R27-L14	01S	93S	.018	27	8
EADCD040RA1	CSP492-10-01-XXX-R27-L14	01S	93S	.018	27	8
EADCD040RA2	CSP492-10-01-XXX-R27-L14	01S	93S	.018	27	8
EADCD050RA1	C10-612-12-01-XXX-R27-L14	01S	93S	.018	8	5
EADCD054GA1	C10-618-18-01-XXX-R27-L14	01S	93S	.018	19	7
EADCD054OA0	C10-618-18-01-XXX-R27-L14	01S	93S	.018	19	7
EADCD056GA2	C10-618-18-01-XXX-R27-L14	01S	93S	.018	19	7
EADCD056GA4	C10-618-18-01-XXX-R27-L14	01S	93S	.018	19	7
EADCD056GA6	C10-618-18-01-XXX-R27-L14	01S	93S	.018	19	7
EADCD056GA8	C10-618-18-01-XXX-R27-L14	01S	93S	.018	19	7
EADCD056OA1	C10-618-18-01-XXX-R27-L14	01S	93S	.018	19	7
EADCD056RA1	C10-618-18-01-XXX-R27-L14	01S	93S	.018	19	7
EADCD056RA4	C10-618-18-01-XXX-R27-L14	01S	93S	.018	19	7
EADCD056RA6	C10-618-18-01-XXX-R27-L14	01S	93S	.018	19	7
EADCF040GA2	C10-416-16-01-XXX-R27-L14	01S	93S	.018	21	7
EADCF040RA1	C10-416-16-01-XXX-R27-L14	01S	93S	.018	21	7
EADCF040RA2	C10-416-16-01-XXX-R27-L14	01S	93S	.018	21	7
EADCF040RA4	C10-416-16-01-XXX-R27-L14	01S	93S	.018	21	7
EADCF056GA1	C10-612-12-01-XXX-R27-L14	01S	93S	.018	8	5
EADCF056GA2	C10-612-12-01-XXX-R27-L14	01S	93S	.018	8	5
EADCF056GA2	C10-612-12-01-XXX-R27-L14	01S	93S	.018	8	5
EADCF056RA1	C10-612-12-01-XXX-R27-L14	01S	93S	.018	8	5
EADCF056RA1	C10-612-12-01-XXX-R27-L14	01S	93S	.018	8	5
EADCF056RA2	C10-612-12-01-XXX-R27-L14	01S	93S	.018	8	5

See last page for other mounting types including low profile options.
Heat sink socket available to reduce heat and noise. Contact Andon for details.

Everlight						
Everlight Model Number	Andon Part Number Replace "XXX" with Terminal Type	Terminal Type		Pin Ø [in]	Figure Number	Page Number
		Thru-Hole	Surface Mount			
EADCF056RA2	C10-612-12-01-XXX-R27-L14	01S	93S	.018	8	5
EADCS030BA2	C10-314-11-01-XXX-R27-L14	01S	93S	.018	15	6
EADCS030BA2	C10-314-11-01-XXX-R27-L14	01S	93S	.018	15	6
EADCS030GA1	C10-314-11-01-XXX-R27-L14	01S	93S	.018	15	6
EADCS030GA1	C10-314-11-01-XXX-R27-L14	01S	93S	.018	15	6
EADCS030GA2	C10-314-11-01-XXX-R27-L14	01S	93S	.018	15	6
EADCS030GA2	C10-314-11-01-XXX-R27-L14	01S	93S	.018	15	6
EADCS030OA1	C10-314-11-01-XXX-R27-L14	01S	93S	.018	15	6
EADCS030OA1	C10-314-11-01-XXX-R27-L14	01S	93S	.018	15	6
EADCS030OA2	C10-314-11-01-XXX-R27-L14	01S	93S	.018	15	6
EADCS030OA2	C10-314-11-01-XXX-R27-L14	01S	93S	.018	15	6
EADCS030RA1	C10-314-11-01-XXX-R27-L14	01S	93S	.018	15	6
EADCS030RA1	C10-314-11-01-XXX-R27-L14	01S	93S	.018	15	6
EADCS030RA2	C10-314-11-01-XXX-R27-L14	01S	93S	.018	15	6
EADCS036GA1	351-210-XXX-R27-B10	01P28	93P28	.028	29	8
EADCS036RA1	351-210-XXX-R27-B10	01P28	93P28	.028	29	8
EADCS039GA1	C10-310-10-01-XXX-R27-L14	01S	93S	.018	13	6
EADCS039GA2	C10-310-10-01-XXX-R27-L14	01S	93S	.018	13	6
EADCS039RA1	C10-310-10-01-XXX-R27-L14	01S	93S	.018	13	6
EADCS039RA2	C10-310-10-01-XXX-R27-L14	01S	93S	.018	13	6
EADCS040RA1	C10-314-10-02-XXX-R27-L14	01S	93S	.018	16	6
EADCS052RA1	CSP591-10-01-XXX-R27-L14	01S	93S	.018	14	6
EADCS052RA2	CSP591-10-01-XXX-R27-L14	01S	93S	.018	14	6
EADCS056GA1	C10-610-10-01-XXX-R27-L14	01S	93S	.018	2	4
EADCS056GA2	C10-610-10-01-XXX-R27-L14	01S	93S	.018	2	4
EADCS056GA4	C10-610-10-01-XXX-R27-L14	01S	93S	.018	2	4
EADCS056RA1	C10-610-10-01-XXX-R27-L14	01S	93S	.018	2	4
EADCS056RA2	C10-610-10-01-XXX-R27-L14	01S	93S	.018	2	4
EADCS056RA3	C10-610-10-01-XXX-R27-L14	01S	93S	.018	2	4
EADCS080RA1	C10-616-13-01-XXX-R27-L14	01S	93S	.018	7	5
EADCS080RA2	C10-616-13-01-XXX-R27-L14	01S	93S	.018	7	5
EADCS100RA2	C10-1210-10-01-XXX-R27-L14	01S	93S	.018	1	4
EADCS224BA2	C10-23610-10-01-XXX-R27-L14	01S	93S	.018	22	7
EADCS224GA2	C10-23610-10-01-XXX-R27-L14	01S	93S	.018	22	7
EADDM070RA1	C10-312-12-01-XXX-R27-L14	01S	93S	.018	3	4
EADDM100RA2	C10-1314-14-01-XXX-R27-L14	01S	93S	.018	4	4
EADDM117AA2	C10-11322-22-01-XXX-R27-L14	01S	93S	.018	28	8
EADDM288GA1	C10-1816-16-01-XXX-R27-L14	01S	93S	.018	20	7
EADDM288GA2	C10-1816-16-01-XXX-R27-L14	01S	93S	.018	20	7
EADDM288RA1	C10-1816-16-01-XXX-R27-L14	01S	93S	.018	20	7
EADDM288YA1	C10-1816-16-01-XXX-R27-L14	01S	93S	.018	20	7
EADLB010RA4	C10-320-20-01-XXX-R27-L14	01S	93S	.018	9	5
EADLB101GA2	CSP200-05-01-XXX-R27-L14	01S	93S	.018	10	5
EADLB101RA2	CSP200-05-01-XXX-R27-L14	01S	93S	.018	10	5
EADLBA10GA1	C10-320-20-01-XXX-R27-L14	01S	93S	.018	9	5
EADLBA10OA1	C10-320-20-01-XXX-R27-L14	01S	93S	.018	9	5
EADLBA10RA1	C10-320-20-01-XXX-R27-L14	01S	93S	.018	9	5
EADLBA10RA1	C10-618-18-01-XXX-R27-L14	01S	93S	.018	19	7
EADLBA10RA3	C10-320-20-01-XXX-R27-L14	01S	93S	.018	9	5
EL2601S(TA)-V-DIP	C10-308-08-01-XXX-R27-L14	01S	93S	.018	6	4
EL3022S(TA)-V-DIP	C10-306-06-01-XXX-R27-L14	01S	93S	.018	23	7
EL3022S(TA)-V-M	C10-406-06-01-XXX-R27-L14	01S	93S	.018	24	7
EL3023S(TA)-V-DIP	C10-306-06-01-XXX-R27-L14	01S	93S	.018	23	7
EL3023S(TA)-V-M	C10-406-06-01-XXX-R27-L14	01S	93S	.018	24	7
EL406A-DIP	C10-304-04-01-XXX-R27-L14	01S	93S	.018	18	6

See last page for other mounting types including low profile options.
Heat sink socket available to reduce heat and noise. Contact Andon for details.

Everlight						
Everlight Model Number	Andon Part Number Replace "XXX" with Terminal Type	Terminal Type		Pin Ø [in]	Figure Number	Page Number
		Thru-Hole	Surface Mount			
EL406A-M	C10-404-04-02-XXX-R27-L14	01S	93S	.018	26	8
EL425A-DIP	C10-304-04-01-XXX-R27-L14	01S	93S	.018	18	6
EL425A-M	C10-404-04-02-XXX-R27-L14	01S	93S	.018	26	8
EL440A-DIP	C10-304-04-01-XXX-R27-L14	01S	93S	.018	18	6
EL440A-M	C10-404-04-02-XXX-R27-L14	01S	93S	.018	26	8
EL440AS1-DIP	C10-304-04-01-XXX-R27-L14	01S	93S	.018	18	6
EL440AS1-M	C10-404-04-02-XXX-R27-L14	01S	93S	.018	26	8
EL814M(A)-DIP	C10-304-04-01-XXX-R27-L14	01S	93S	.018	18	6
EL814M(A)-M	C10-404-04-02-XXX-R27-L14	01S	93S	.018	26	8
EL814S(A)(TA)-DIP	C10-304-04-01-XXX-R27-L14	01S	93S	.018	18	6
EL814S(A)(TA)-M	C10-404-04-02-XXX-R27-L14	01S	93S	.018	26	8
EL814S(TA)-DIP	C10-304-04-01-XXX-R27-L14	01S	93S	.018	18	6
EL814S(TA)-M	C10-404-04-02-XXX-R27-L14	01S	93S	.018	26	8
EL814S1(A)(TA)-DIP	C10-304-04-01-XXX-R27-L14	01S	93S	.018	18	6
EL814S1(A)(TA)-M	C10-404-04-02-XXX-R27-L14	01S	93S	.018	26	8
EL814S1(TA)-V-DIP	C10-304-04-01-XXX-R27-L14	01S	93S	.018	18	6
EL814S1(TA)-V-M	C10-404-04-02-XXX-R27-L14	01S	93S	.018	26	8
EL817S1(A)(TU)-V-DIP	C10-304-04-01-XXX-R27-L14	01S	93S	.018	18	6
EL817S1(A)(TU)-V-M	C10-404-04-02-XXX-R27-L14	01S	93S	.018	26	8
EL851S(TA)-DIP	C10-304-04-01-XXX-R27-L14	01S	93S	.018	18	6
EL851S(TA)-M	C10-404-04-02-XXX-R27-L14	01S	93S	.018	26	8
EL852-DIP	C10-304-04-01-XXX-R27-L14	01S	93S	.018	18	6
EL852-M	C10-404-04-02-XXX-R27-L14	01S	93S	.018	26	8
ELT3063-DIP	C10-304-04-01-XXX-R27-L14	01S	93S	.018	18	6
ELT3063-M	C10-404-04-02-XXX-R27-L14	01S	93S	.018	26	8
ELW137	C10-308-08-01-XXX-R27-L14	01S	93S	.018	6	4
ELW2601S(TA)-V-DIP	C10-308-08-01-XXX-R27-L14	01S	93S	.018	6	4
ELW2601S(TA)-V-M	C10-408-08-01-XXX-R27-L14	01S	93S	.018	5	4
ELW2601S(TA)-V-DIP	C10-308-08-01-XXX-R27-L14	01S	93S	.018	6	4
ELW26-DIP SERIES	C10-308-08-01-XXX-R27-L14	01S	93S	.018	6	4
ELW26-DIP SERIES	C10-408-08-01-XXX-R27-L14	01S	93S	.018	5	4
EWL2611S(TA)-V-M	C10-408-08-01-XXX-R27-L14	01S	93S	.018	5	4
H11AX-DIP SERIES	C10-306-06-01-XXX-R27-L14	01S	93S	.018	23	7
H11AXSERIESM	C10-406-06-01-XXX-R27-L14	01S	93S	.018	24	7
H11B-DIP SERIES	C10-306-06-01-XXX-R27-L14	01S	93S	.018	23	7
H11B-M-SERIES	C10-406-06-01-XXX-R27-L14	01S	93S	.018	24	7
H11L1M-V-DIP	C10-306-06-01-XXX-R27-L14	01S	93S	.018	23	7
H11L1M-V-M	C10-406-06-01-XXX-R27-L14	01S	93S	.018	24	7
H11L1S(TA)-V-DIP	C10-306-06-01-XXX-R27-L14	01S	93S	.018	23	7
H11L1S(TA)-V-M	C10-406-06-01-XXX-R27-L14	01S	93S	.018	24	7
H11L2(TA)-V-DIP	C10-306-06-01-XXX-R27-L14	01S	93S	.018	23	7
H11L2-M	C10-406-06-01-XXX-R27-L14	01S	93S	.018	24	7
H11L3(TA)DIP	C10-306-06-01-XXX-R27-L14	01S	93S	.018	23	7
H11L3-M	C10-406-06-01-XXX-R27-L14	01S	93S	.018	24	7
H11L3S(TA)-V-DIP	C10-306-06-01-XXX-R27-L14	01S	93S	.018	23	7
H11L3S(TA)-V-M	C10-406-06-01-XXX-R27-L14	01S	93S	.018	24	7
T12113-MSERIES	C10-406-06-01-XXX-R27-L14	01S	93S	.018	24	7
TIL 113-DIP SERIES	C10-306-06-01-XXX-R27-L14	01S	93S	.018	23	7

See last page for other mounting types including low profile options.
Heat sink socket available to reduce heat and noise. Contact Andon for details.

EVERLIGHT *Continued*

Top View Shown

Units: in [mm]

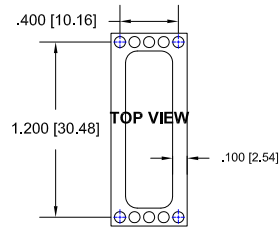

FIG.1

Thru-Hole: C10-1210-10-01-01S-R27-L14
Surface Mount: C10-1210-10-01-93S-R27-L14

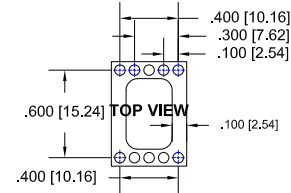

FIG.2

Thru-Hole: C10-610-10-01-01S-R27-L14
Surface Mount: C10-610-10-01-93S-R27-L14

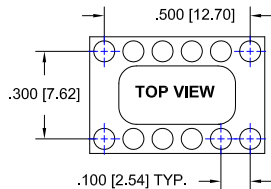

FIG.3

Thru-Hole: C10-312-12-01-01S-R27-L14
Surface Mount: C10-312-12-01-93S-R27-L14

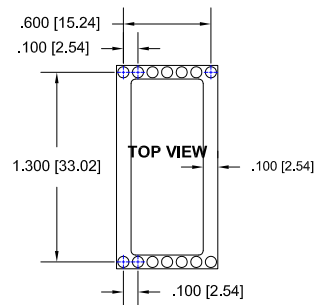

FIG.4

Thru-Hole: C10-1314-14-01-01S-R27-L14
Surface Mount: C10-1314-14-01-93S-R27-L14

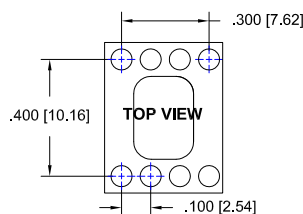

FIG.5

Thru-Hole: C10-408-08-01-01S-R27-L14
Surface Mount: C10-408-08-01-93S-R27-L14

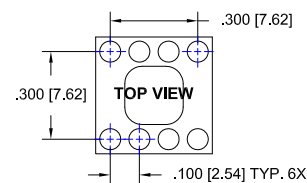

FIG.6

Thru-Hole: C10-308-08-01-01S-R27-L14
Surface Mount: C10-308-08-01-93S-R27-L14

EVERLIGHT *Continued*

Top View Shown

Units: in [mm]

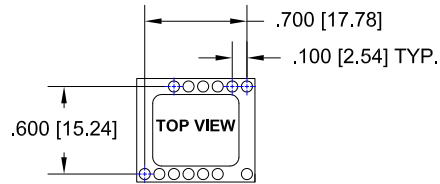

FIG.7

Thru-Hole: C10-616-13-01-01S-R27-L14
Surface Mount: C10-616-13-01-93S-R27-L14

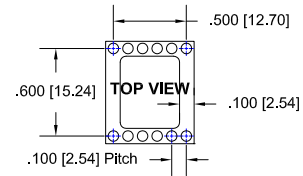

FIG.8

Thru-Hole: C10-612-12-01-01S-R27-L14
Surface Mount: C10-612-12-01-93S-R27-L14

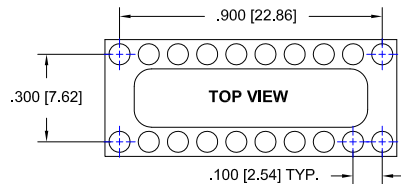

FIG.9

Thru-Hole: C10-320-20-01-01S-R27-L14
Surface Mount: C10-320-20-01-93S-R27-L14

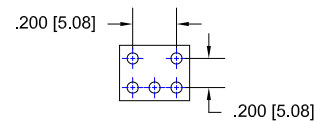

FIG.10

Thru-Hole: CSP200-05-01-01S-R27-L14
Surface Mount: CSP200-05-01-93S-R27-L14

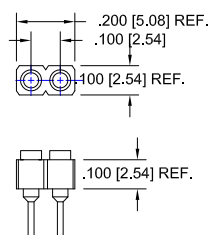

FIG.11

Thru-Hole: 301-002-01P28-R27-B10
Surface Mount: 310-002-93P28-R27-B10

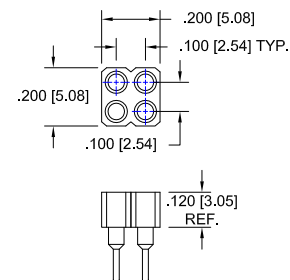

FIG.12

Thru-Hole: 351-204-01P28-R27-B10
Surface Mount: 351-204-93P28-R27-B10

EVERLIGHT *Continued*

Top View Shown

Units: in [mm]

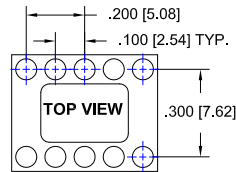

FIG.13

Thru-Hole: C10-310-10-01-01S-R27-L14
Surface Mount: C10-310-10-01-93S-R27-L14

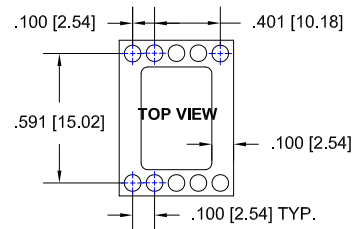

FIG.14

Thru-Hole: CSP591-10-01-01S-R27-L14
Surface Mount: CSP591-10-01-93S-R27-L14

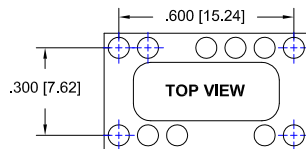

FIG.15

Thru-Hole: C10-314-11-01-01S-R27-L14
Surface Mount: C10-314-11-01-93S-R27-L14

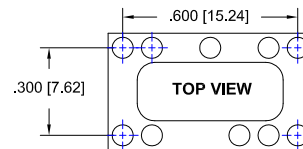

FIG.16

Thru-Hole: C10-314-10-02-01S-R27-L14
Surface Mount: C10-314-10-02-93S-R27-L14

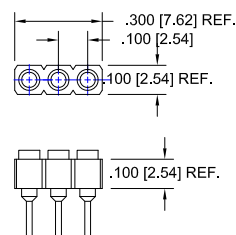

FIG.17

Thru-Hole: 301-003-01P28-R27-B10
Surface Mount: 310-003-93P28-R27-B10

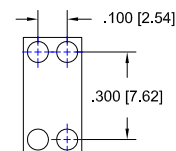

FIG.18

Thru-Hole: C10-304-04-01-01S-R27-L14
Surface Mount: C10-304-04-01-93S-R27-L14

EVERLIGHT Continued

Top View Shown

Units: in [mm]

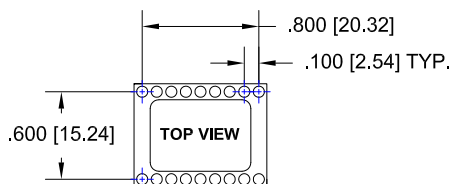

FIG.19

Thru-Hole: C10-618-18-01-01S-R27-L14
Surface Mount: C10-618-18-01-93S-R27-L14

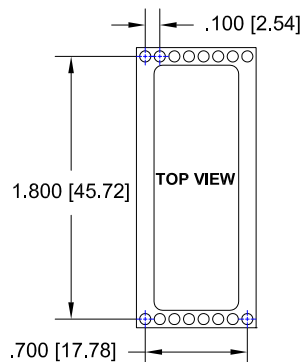

FIG.20

Thru-Hole: C10-1816-16-01-01S-R27-L14
Surface Mount: C10-1816-16-01-93S-R27-L14

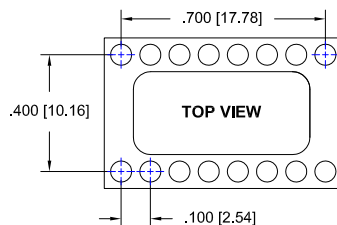

FIG.21

Thru-Hole: C10-416-16-01-01S-R27-L14
Surface Mount: C10-416-16-01-93S-R27-L14

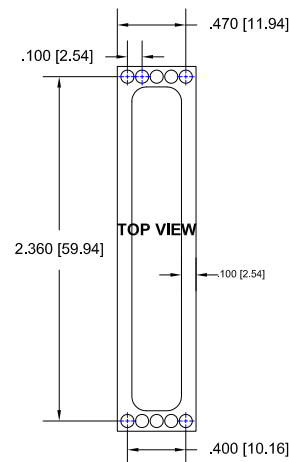

FIG.22

Thru-Hole: C10-23610-10-01-01S-R27-L14
Surface Mount: C10-23610-10-01-93S-R27-L14

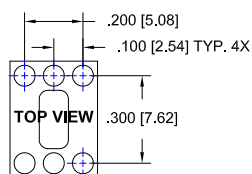

FIG.23

Thru-Hole: C10-306-06-01-01S-R27-L14
Surface Mount: C10-306-06-01-93S-R27-L14

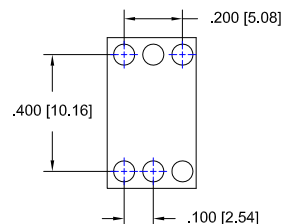

FIG.24

Thru-Hole: C10-406-06-01-01S-R27-L14
Surface Mount: C10-406-06-01-93S-R27-L14

EVERLIGHT *Continued*

Top View Shown

Units: in [mm]

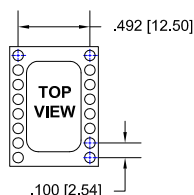

FIG.25

Thru-Hole: CSP492-16-01-01S-R27-L14
Surface Mount: CSP492-16-01-93S-R27-L14

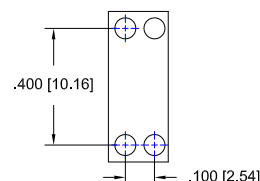

FIG.26

Thru-Hole: C10-404-04-02-01S-R27-L14
Surface Mount: C10-404-04-02-93S-R27-L14

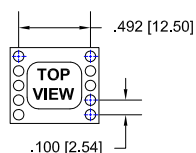

FIG.27

Thru-Hole: CSP492-10-01-01S-R27-L14
Surface Mount: CSP492-10-01-93S-R27-L14

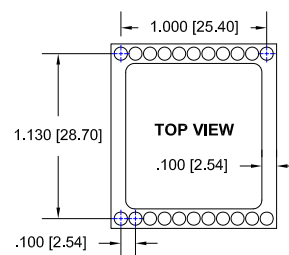

FIG.28

Thru-Hole: C10-11322-22-01-01S-R27-L14
Surface Mount: C10-11322-22-01-93S-R27-L14

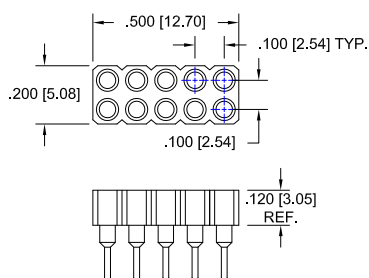

FIG.29

Thru-Hole: 351-210-01P28-R27-B10
Surface Mount: 351-210-93P28-R27-B10

EVERLIGHT *Continued*

Top View Shown

Units: in [mm]

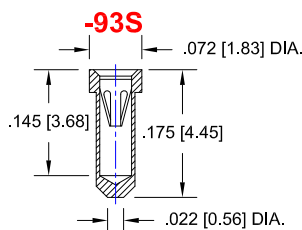
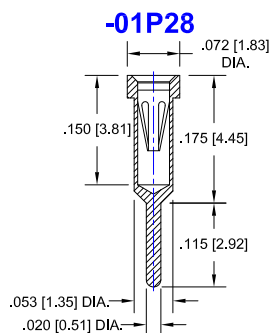
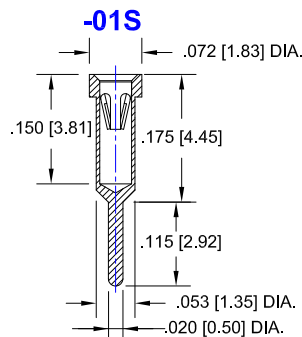
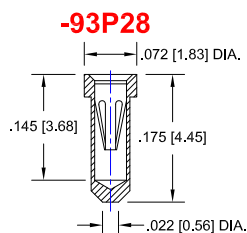

Technical Information

Material:

Insulator: Hi-Temp UL 94V-O
Terminal: Brass, per ASTM-B16
Contact: BeCu, Per ASTM-B194

Plating: RoHS COMPLIANT

R17 TERMINAL: MATTE TIN / CONTACT: GOLD
R27 TERMINAL: GOLD / CONTACT: GOLD
R32 TERMINAL: MATTE TIN / CONTACT: TIN
OTHER PLATINGS AVAILABLE

Terminal Acceptance and Forces

Thru Hole Terminals				Surface Mount Terminals			
Thru Hole Terminal	Accepts Pin Diameter	Insertion Force	Withdrawal Force	Surface Mount Terminal	Accepts Pin Diameter	Insertion Force	Withdrawal Force
-01S	Ø.018 [Ø0.46]	9.0 oz Avg.	2.0 oz Min	-93S	Ø.018 [Ø0.46]	9.0 oz Avg.	2.0 oz Min
-01P28	Ø.028 [Ø0.71]	0.70 oz Avg.	.35 oz Min	-93P28	Ø.028 [Ø0.71]	0.70 oz Avg.	.35 oz Min

MOUNTING OPTIONS

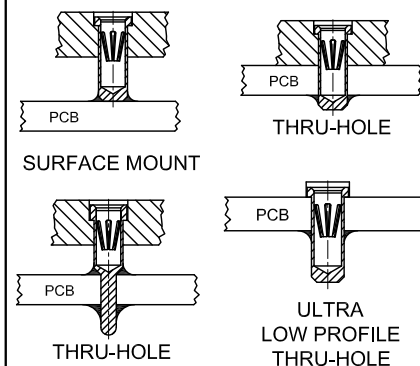

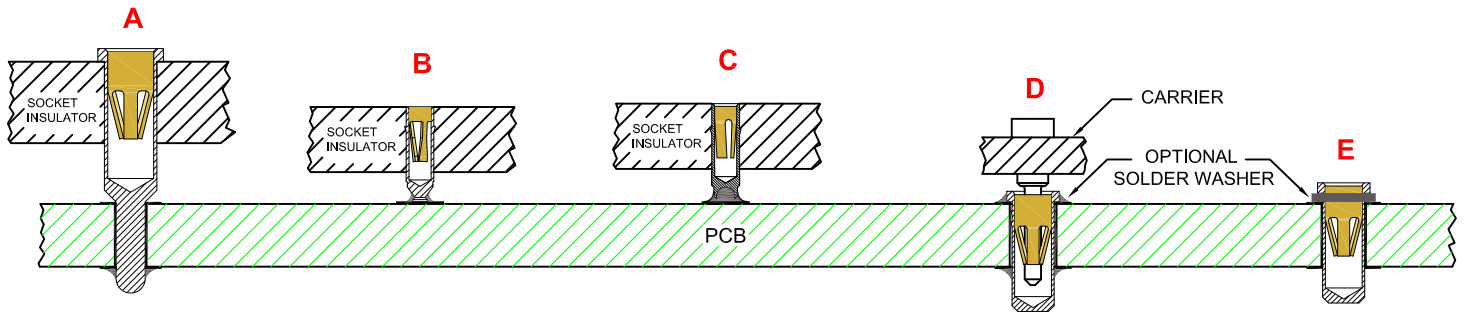

**THRU-HOLE
SOCKET**

SMD-SOCKET

**SMD
ROLLERBALL®
SOCKET
(PATENTED)**

**REMOVABLE
CARRIER
WITH ULTRA-LOW
PROFILE PIN SOCKETS**

**INDIVIDUAL
ULTRA-LOW PROFILE
PIN SOCKETS
(BEFORE SOLDERING)**

**ROLLERBALL®
SOCKET**

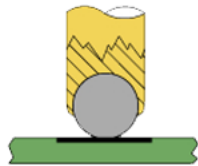

BEFORE SOLDERING

**ROLLERBALL®
SOCKET**



AFTER SOLDERING

A more reliable solder joint for surface mount applications !

ULTRA LOW PROFILE SIP/DIP/PGA CARRIER ASSEMBLY See 'D' above

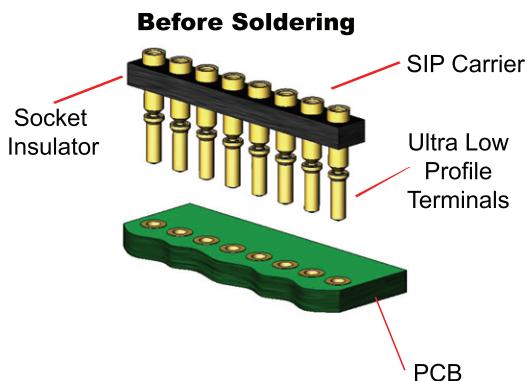

During Soldering

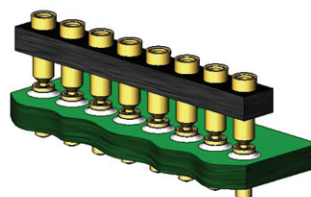

After Soldering

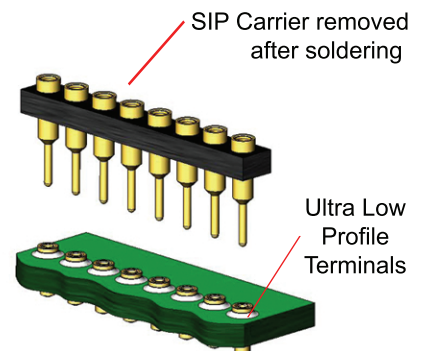

Available with or without solder washer