

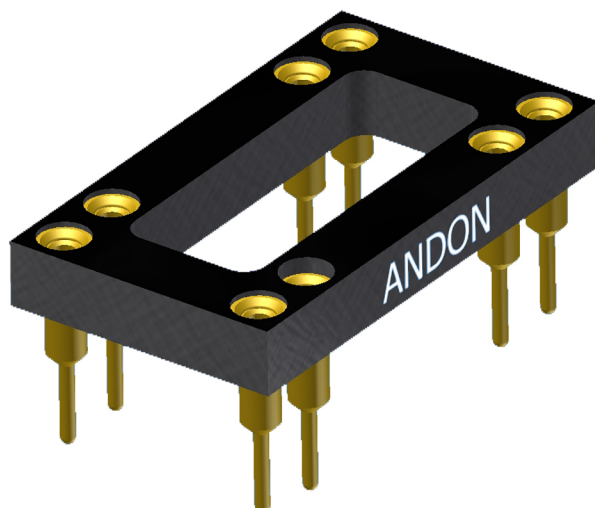

RoHS Compliant
ISO 9001
Certified

POWER CONVERTER SOCKETS FOR HASCO RELAYS AND ELECTRONICS INTERNATIONAL CORP.



***Largest Line of High Reliability Power Converter Sockets
with Hi-Rel Contacts***

HASCO RELAYS AND ELECTRONICS INTERNATIONAL CORP. is a trade mark of HASCO RELAYS AND ELECTRONICS INTERNATIONAL CORP.
www.andonelect.com or www.andonelectronics.com

HASCO RELAYS AND ELECTRONICS INTERNATIONAL CORP.						
Model Number	Andon Part Number Replace "XXX" with Terminal Type	Terminal Type		Pin Ø [in]	Figure Number	Page Number
		Thru-Hole	Surface Mount			
700 SERIES	C10-314-08-02-XXX-R27-L14	01S	93S	.018	10	2
711 SERIES	C20-005-04-01-XXX-R27-L14	01S	93S	.018	16	3
712 & 713 & 714 SERIES	C10-011-04-01-XXX-R27-L14	01S	93S	.018	15	3
CAS/CS SERIES	C10-308-08-01-XXX-R27-L14	01S	93S	.018	13	3
HBS SERIES	C10-410-06-02-XXX-R27-L14	01S	93S	.018	9	2
HPR-1A	CSP300-04-01-XXX-R27-L14	295V	439V	.030	1	1
HPR-1C	CSP300-05-01-XXX-R27-L14	295V	439V	.030	2	1
KSD SERIES	CSP500-08-01-XXX-R27-L14	433E	285E	.040	6	2
MHR SERIES	CSP500-05-01-XXX-R27-L14	502EP55	503EP55	.040/.060	7	2
RPR	CSP300-04-02-XXX-R27-L14	295V	439V	.030	3	1
RPR-K	CSP300-05-02-XXX-R27-L14	295V	439V	.030	4	1
SLT SERIES	CSP394-05-01-XXX-R27-L14	433E	285E	.040	11	3
SPR-L SERIES R TYPE	CSP800-05-01-XXX-R27-L14	01S	93S	.018	17	3
SPR-L SERIES K TYPE	CSP800-09-01-XXX-R27-L14	01S	93S	.018	5	2
SSD SERIES	CSP500-05-02-XXX-R27-L14	502EP55	503EP55	.040/.060	12	3
T SERIES	C10-310-10-01-XXX-R27-L14	01S	93S	.018	14	3
TR SERIES	CSP185-04-01-XXX-R27-L14	295V	439V	.030	8	2

See last page for other mounting types including low profile options.
Heat sink socket available to reduce heat and noise. Contact Andon for details.

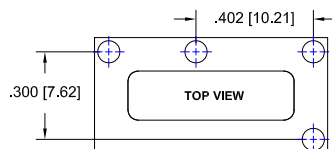

FIG. 1

Thru-Hole: CSP300-04-01-295V-R27-L14
Surface Mount: CSC300-04-01-439V-R27-L14

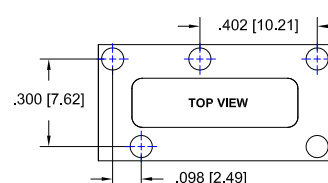

FIG. 2

Thru-Hole: CSP300-05-01-295V-R27-L14
Surface Mount: CSC300-05-01-439V-R27-L14

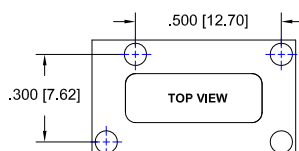

FIG. 3

Thru-Hole: CSP300-04-02-295V-R27-L14
Surface Mount: CSC300-04-02-439V-R27-L14

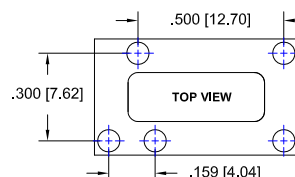

FIG. 4

Thru-Hole: CSP300-05-02-295V-R27-L14
Surface Mount: CSC300-05-02-439V-R27-L14

HASCO RELAYS AND ELECTRONICS INTERNATIONAL CORP. *Continued*

Top View Shown

Units: in [mm]

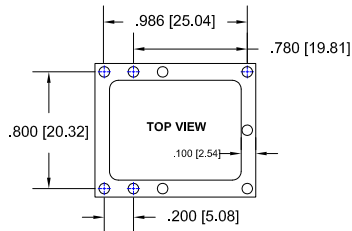

FIG. 5

Thru-Hole: CSP800-09-01-01S-R27-L14
Surface Mount: CSP800-09-01-93S-R27-L14

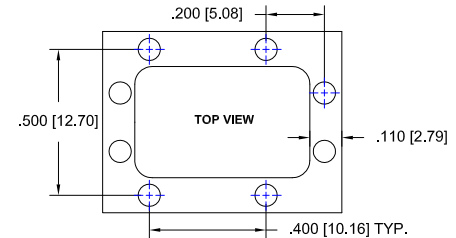

FIG. 6

Thru-Hole: CSP500-08-01-433E-R27-L14
Surface Mount: CSP500-08-01-285E-R27-L14

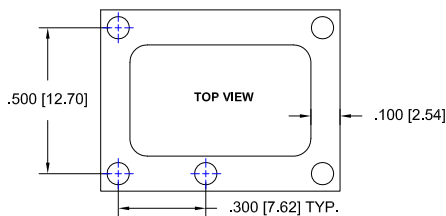

FIG. 7

Thru-Hole: CSP500-05-01-502EP55-R27-L14
Surface Mount: CSP500-05-01-503EP55-R27-L14

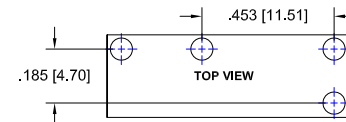

FIG. 8

Thru-Hole: CSP185-04-01-295V-R27-L14
Surface Mount: CSC185-04-01-439V-R27-L14

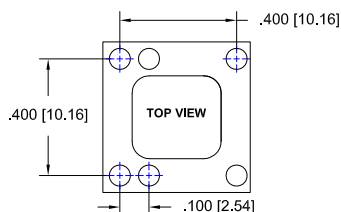

FIG. 9

Thru-Hole: C10-410-06-02-01S-R27-L14
Surface Mount: C10-410-06-02-93S-R27-L14

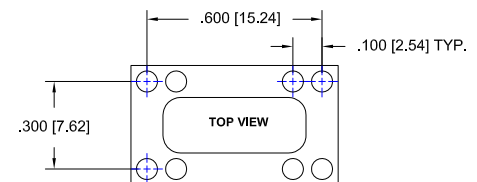

FIG. 10

Thru-Hole: C10-314-08-02-01S-R27-L14
Surface Mount: C10-314-08-02-93S-R27-L14

HASCO RELAYS AND ELECTRONICS INTERNATIONAL CORP. *Continued*

Top View Shown

Units: in [mm]

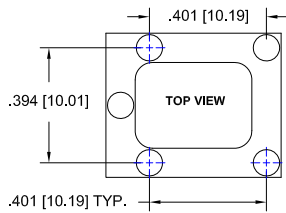

FIG. 11

Thru-Hole: CSP394-05-01-433E-R27-L14
Surface Mount: CSP394-05-01-285E-R27-L14

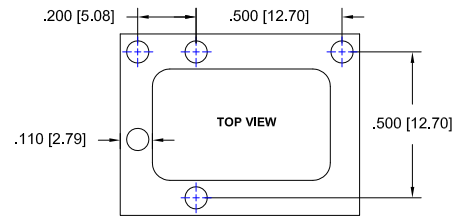

FIG. 12

Thru-Hole: CSP500-05-02-502EP55-R27-L14
Surface Mount: CSP500-05-02-503EP55-R27-L14

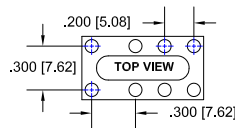

FIG. 13

Thru-Hole: C20-308-08-01-01S-R27-L14
Surface Mount: C20-308-08-01-93S-R27-L14

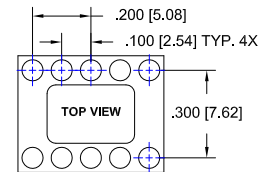

FIG. 14

Thru-Hole: C10-310-10-01-01S-R27-L14
Surface Mount: C10-310-10-01-93S-R27-L14

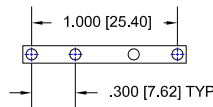

FIG. 15

Thru-Hole: C10-011-04-01-01S-R27-L14
Surface Mount: C10-011-04-01-93S-R27-L14

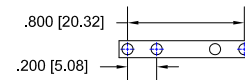

FIG. 16

Thru-Hole: C20-005-04-01-01S-R27-L14
Surface Mount: C20-005-04-01-93S-R27-L14

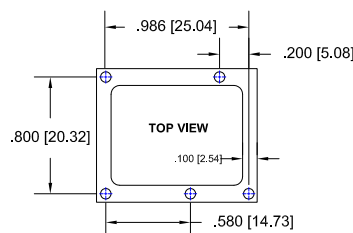
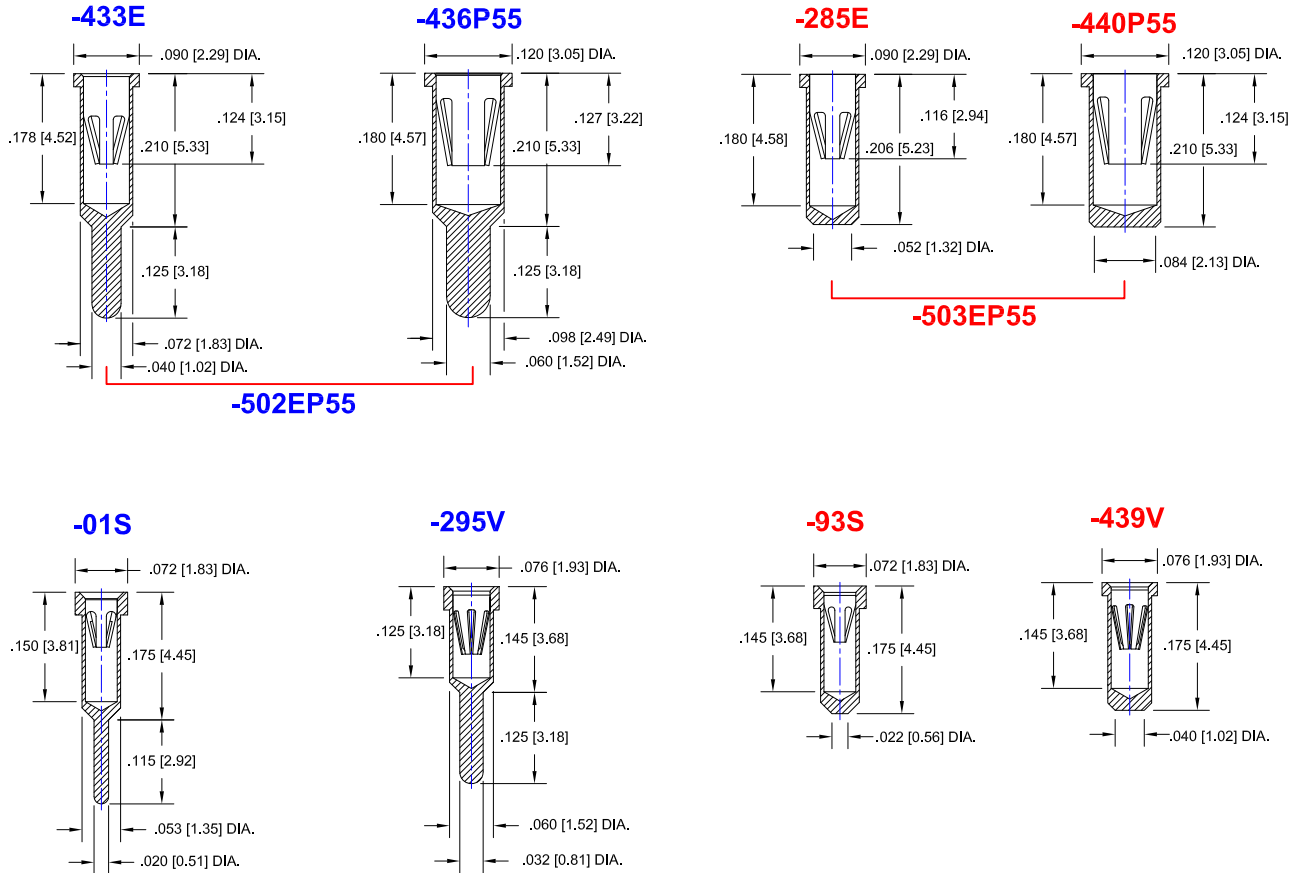

FIG. 17

Thru-Hole: CSP800-05-01-01S-R27-L14
Surface Mount: CSP800-05-01-93S-R27-L14

HASCO RELAYS AND ELECTRONICS INTERNATIONAL CORP. *Continued*

Socket Terminal Details Cross Section View Shown Units: in [mm]



Technical Information

Material:

Insulator: Hi-Temp UL 94V-O
 Terminal: Brass, per ASTM-B16
 Contact: BeCu, Per ASTM-B194

Plating: RoHS COMPLIANT

R17 TERMINAL: MATTE TIN / CONTACT: GOLD

R27 TERMINAL: GOLD / CONTACT: GOLD

R32 TERMINAL: MATTE TIN / CONTACT: TIN

OTHER PLATINGS AVAILABLE

Terminal Acceptance and Forces							
Thru Hole Terminals				Surface Mount Terminals			
Thru Hole Terminal	Accepts Pin Diameter	Insertion Force	Withdrawal Force	Surface Mount Terminal	Accepts Pin Diameter	Insertion Force	Withdrawal Force
-01S	Ø.018 [Ø0.46]	9.0 oz Max	2.0 oz Min	-93S	Ø.018 [Ø0.46]	9.0 oz Max	2.0 oz Min
-295V	Ø.030 [Ø0.76]	13.2 oz Max	3.5 oz Min	-439V	Ø.030 [Ø0.76]	13.2 oz Max	3.5 oz Min
-433E	Ø.040 [Ø1.02]	36.0 oz Max	3.9 oz Min	-285E	Ø.040 [Ø1.02]	36.0 oz Max	3.9 oz Min
-436P55	Ø.060 [Ø1.52]	15.5 oz Max	2.1 oz Min	-440P55	Ø.060 [Ø1.52]	15.5 oz Max	2.1 oz Min

MOUNTING OPTIONS

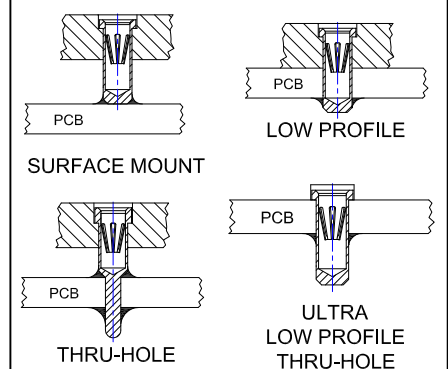

©Copyright 2017 Andon Electronics Corporation. All Rights Reserved. This material is protected under US and other copyrights and may not be copied, sold, or redistributed in any form without written permission of Andon Electronics Corporation. Copyrights and trademarks are property of their respective companies. We reserve the right to change specifications without notice. Andon makes no warranty, expressed or implied, as to the suitability of the sockets for the intended purpose.

"ANDON PROPRIETARY INFORMATION"

RoHS Compliant

*Sockets are not drawn to scale
 HASCO RELAYS AND ELECTRONICS INTERNATIONAL CORP 5/25/2017

ANDON ELECTRONICS CORPORATION
 4 Court Drive, Lincoln RI 02865, United States of America

www.andonelectronics.com or www.andonelect.com
 Phone 401-333-0388 Fax 401-333-0287
 Email Info@andonelect.com

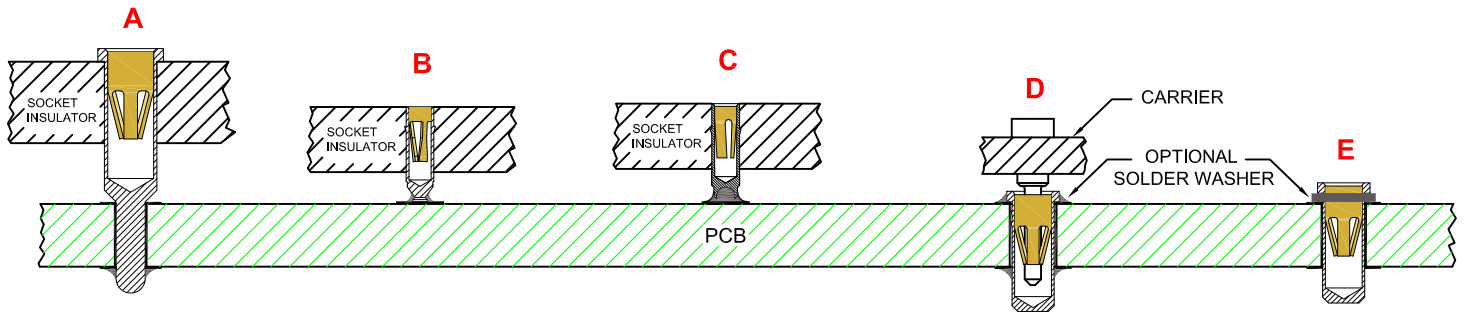

**THRU-HOLE
SOCKET**

SMD-SOCKET

**SMD
ROLLERBALL®
SOCKET
(PATENTED)**

**REMOVABLE
CARRIER
WITH ULTRA-LOW
PROFILE PIN SOCKETS**

**INDIVIDUAL
ULTRA-LOW PROFILE
PIN SOCKETS
(BEFORE SOLDERING)**

**ROLLERBALL®
SOCKET**

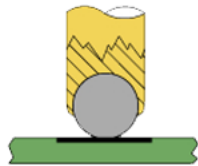

BEFORE SOLDERING

**ROLLERBALL®
SOCKET**



AFTER SOLDERING

A more reliable solder joint for surface mount applications !

ULTRA LOW PROFILE SIP/DIP/PGA CARRIER ASSEMBLY See 'D' above

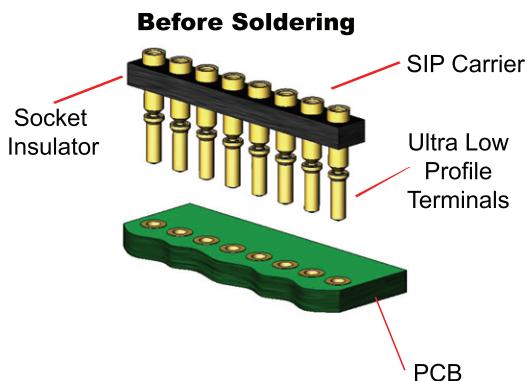

During Soldering

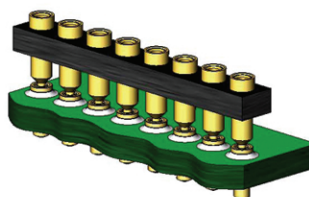

After Soldering

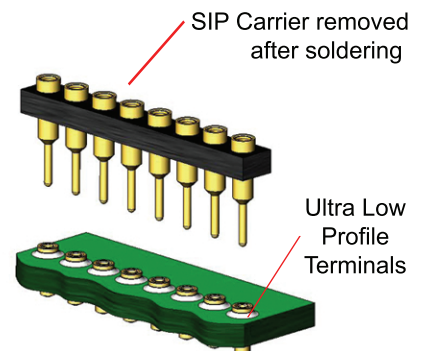

Available with or without solder washer