



RoHS Compliant  
ISO 9001  
Certified

## ***POWER CONVERTER SOCKETS FOR ARTESYN***



***Largest Line of High Reliability Power Converter Sockets  
with Hi-Rel Contacts***

[www.andonelect.com](http://www.andonelect.com) or [www.andonelectronics.com](http://www.andonelectronics.com)

ARTESYN						
Model Number	Andon Part Number Replace "XXX" with Terminal Type	Terminal Type		Pin Ø [in]	Figure Number	Page Number
		Thru-Hole	Surface Mount			
AEE 40W SERIES	C10-1818-06-01-XXX-R27-L14	433E	285E	.040	9	3
AEE SERIES	C10-818-04-01-XXX-R27-L14	433E	285E	.040	1	2
AEE SERIES 40 WATTS	C10-1818-06-01-XXX-R27-L14	433E	285E	.040	9	3
AEE SERIES 50 WATTS	C10-1818-06-01-XXX-R27-L14	433E	285E	.040	9	3
AEE10W-M SERIES	CSP2000-08-01-XXX-R27-L14	502EP55	503EP55	.040/.060	7	3
AET DUAL SERIES	C10-1826-07-01-XXX-R27-L14	433E	285E	.040	8	3
AET SINGLE SERIES	C10-1818-06-01-XXX-R27-L14	433E	285E	.040	9	3
AG200 SERIES	CSP2000-08-01-XXX-R27-L14	502EP55	503EP55	.040/.060	7	3
AGH150 SERIES	CSP1900-09-01-XXX-R27-L14	507EP72	508EP72	.040/.080	3	2
AGH360 SERIES	CSP1900-09-01-XXX-R27-L14	507EP72	508EP72	.040/.080	3	2
AGQ100 SERIES	CSP2000-08-01-XXX-R27-L14	502EP55	503EP55	.040/.060	7	3
AGQ150 SERIES	CSP2000-08-01-XXX-R27-L14	502EP55	503EP55	.040/.060	7	3
AGQ300 SERIES	CSP2000-08-01-XXX-R27-L14	502EP55	503EP55	.040/.060	7	3
ALD15 SERIES	CSP2000-08-01-XXX-R27-L14	502EP55	503EP55	.040/.060	7	3
ASA SERIES	C10-620-08-01-XXX-R27-L14	01S	93S	.018	6	2
ATA SERIES	C10-416-07-01-XXX-R27-L14	01S	93S	.018	4	2
AV050 SERIES	CSP2000-08-01-XXX-R27-L14	502EP55	503EP55	.040/.060	7	3
AV075 SERIES	CSP2000-08-01-XXX-R27-L14	502EP55	503EP55	.040/.060	7	3
AV075B	CSP2000-08-01-XXX-R27-L14	502EP55	503EP55	.040/.060	7	3
AVD100 SERIES	CSP2000-08-01-XXX-R27-L14	502EP55	503EP55	.040/.060	7	3
AVD50 SERIES	CSP2000-08-01-XXX-R27-L14	502EP55	503EP55	.040/.060	7	3
AVD75 SERIES	CSP2000-08-01-XXX-R27-L14	502EP55	503EP55	.040/.060	7	3
AVD85 SERIES	CSP2000-08-01-XXX-R27-L14	502EP55	503EP55	.040/.060	7	3
AVE200 SERIES	CSP1900-09-01-XXX-R27-L14	507EP72	508EP72	.040/.080	3	2
AVE300 SERIES	CSP1900-09-01-XXX-R27-L14	507EP72	508EP72	.040/.080	3	2
AVE350-24 SERIES	CSP1900-09-01-XXX-R27-L14	507EP72	508EP72	.040/.080	3	2
AVE350B SERIES	CSP1900-09-01-XXX-R27-L14	507EP72	508EP72	.040/.080	3	2
AVE450B SERIES	CSP1900-09-01-XXX-R27-L14	507EP72	508EP72	.040/.080	3	2
AVE600 SERIES	CSP1900-09-01-XXX-R27-L14	507EP72	508EP72	.040/.080	3	2
AVO100	CSP2000-08-01-XXX-R27-L14	502EP55	503EP55	.040/.060	7	3
AVO120 SERIES	CSP2000-08-01-XXX-R27-L14	502EP55	503EP55	.040/.060	7	3
AVO200 SERIES	CSP2000-08-01-XXX-R27-L14	502EP55	503EP55	.040/.060	7	3
AVO240-48S12-6L	CSP2000-05-03-XXX-R27-L14	502EP55	503EP55	.040/.060	2	2
AVO240-48S12B-6L	CSP2000-05-03-XXX-R27-L14	502EP55	503EP55	.040/.060	2	2
AVQ300 SERIES	CSP2000-08-01-XXX-R27-L14	502EP55	503EP55	.040/.060	7	3
AVQ400 SERIES	CSP2000-08-01-XXX-R27-L14	502EP55	503EP55	.040/.060	7	3
AXA SERIES	C10-818-06-01-XXX-R27-L14	433E	285E	.040	5	2
IBC04-36S12	CSP2000-05-03-XXX-R27-L14	502EP55	503EP55	.040/.060	2	2
LESB SERIES	CSP2000-08-01-XXX-R27-L14	502EP55	503EP55	.040/.060	7	3
RFB300	CSP1900-09-01-XXX-R27-L14	507EP72	508EP72	.040/.080	3	2
RFB350	CSP1900-09-01-XXX-R27-L14	507EP72	508EP72	.040/.080	3	2

See last page for other mounting types including low profile options.  
Heat sink socket available to reduce heat and noise. Contact Andon for details.

## ARTESYN Continued

### Top View Shown

Units: in [mm]

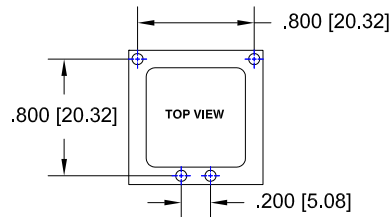

**FIG. 1**

Thru-Hole: C10-818-04-01-433E-R27-L14  
Surface Mount: C10-818-04-01-285E-R27-L14

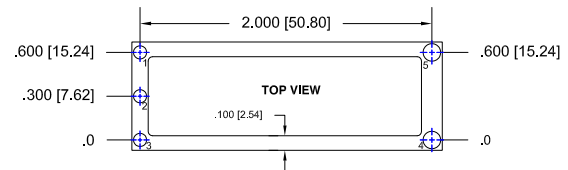

**FIG. 2**

Thru-Hole: CSP2000-05-03-502EP55-R27-L14  
Surface Mount: CSP2000-05-03-503EP55-R27-L14

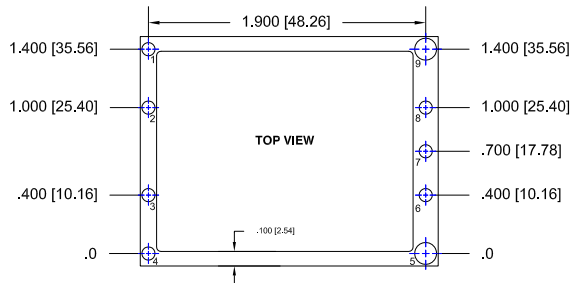

**FIG. 3**

Thru-Hole: CSP1900-09-01-507EP72-R27-L14  
Surface Mount: CSP1900-09-01-508EP72-R27-L14

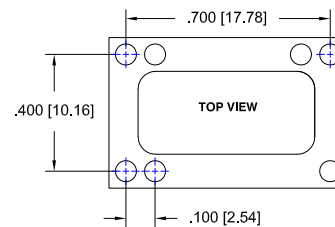

**FIG. 4**

Thru-Hole: C10-416-07-01-01S-R27-L14  
Surface Mount: C10-416-07-01-93S-R27-L14

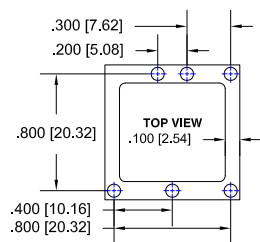

**FIG. 5**

Thru-Hole: C10-818-06-01-433E-R27-L14  
Surface Mount: C10-818-06-01-285E-R27-L14

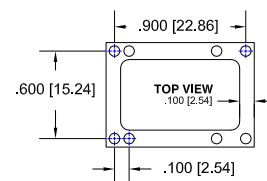

**FIG. 6**

Thru-Hole: C10-620-08-01-01S-R27-L14  
Surface Mount: C10-620-08-01-93S-R27-L14

## ARTESYN Continued Top View Shown Units: in [mm]

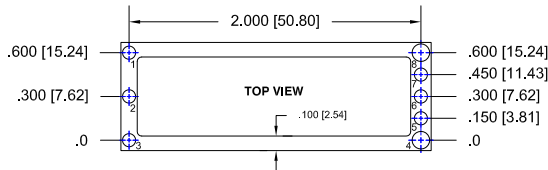

**FIG. 7**

Pins 1-3, 5-7 are Ø.040 [Ø1.02]  
Pins 4 and 8 are Ø.062 [Ø1.57]

Thru-Hole: CSP2000-08-01-**502EP55**-R27-L14  
Surface Mount: CSP2000-08-01-**503EP55**-R27-L14

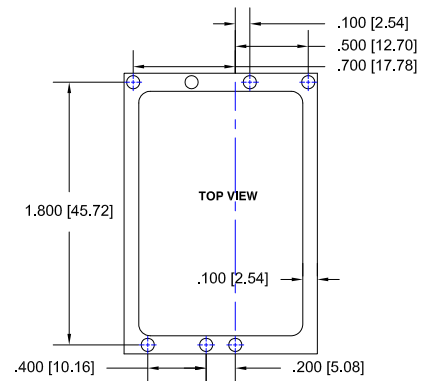

**FIG. 8**

Thru-Hole: C10-1826-07-01-**433E**-R27-L14  
Surface Mount: C10-1826-07-01-**285E**-R27-L14

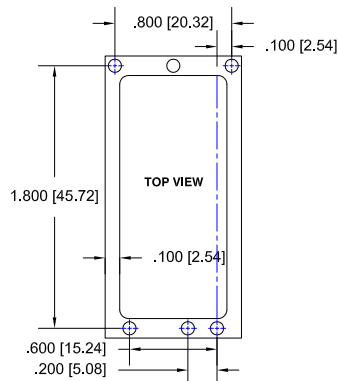

**FIG. 9**

Thru-Hole: C10-1818-06-01-**433E**-R27-L14  
Surface Mount: C10-1818-06-01-**285E**-R27-L14



## ARTESYN Continued

### Socket Terminal Details

Cross Section View Shown  
Units: in [mm]

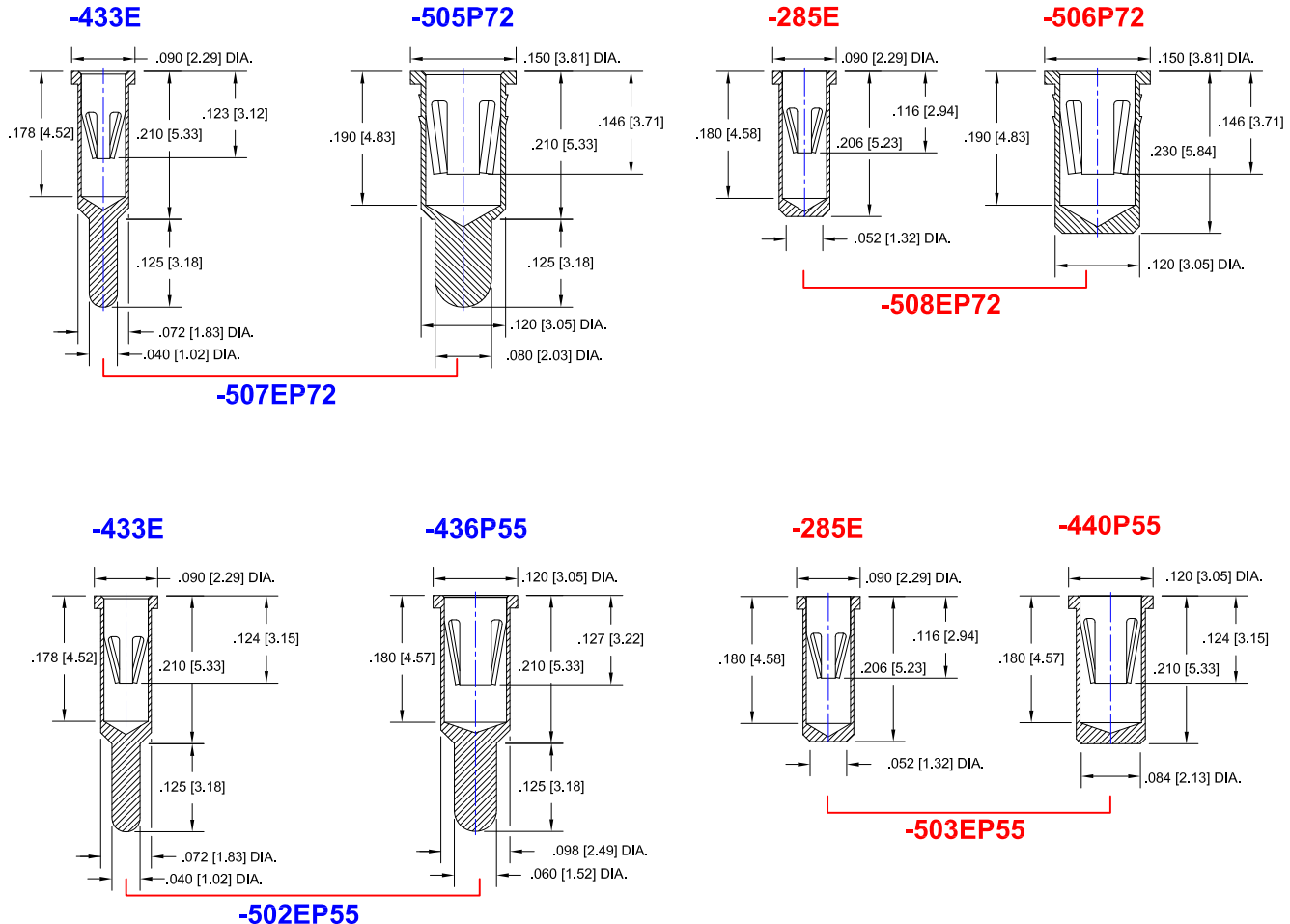

### Material:

Insulator: Hi-Temp UL 94V-O  
Terminal: Brass, per ASTM-B16  
Contact: BeCu, Per ASTM-B194

**Plating: RoHS COMPLIANT**  
**R27 TERMINAL: GOLD / CONTACT: GOLD**  
**R29 TERMINAL: TIN / CONTACT: GOLD**  
**OTHER PLATINGS AVAILABLE**

### Terminal Acceptance and Forces

Thru Hole Terminals				Surface Mount Terminals			
Thru Hole Terminal	Accepts Pin Diameter	Insertion Force	Withdrawal Force	Surface Mount Terminal	Accepts Pin Diameter	Insertion Force	Withdrawal Force
-01S	Ø.018 [Ø0.46]	9.0 oz Max	2.0 oz Min	-93S	Ø.018 [Ø0.46]	9.0 oz Max	2.0 oz Min
-433E	Ø.040 [Ø1.02]	36.0 oz Max	3.9 oz Min	-285E	Ø.040 [Ø1.02]	36.0 oz Max	3.9 oz Min
-505P72	Ø.080 [Ø2.03]	48 oz Max	8.0 oz Min	-506P72	Ø.080 [Ø2.03]	48 oz Max	8.0 oz Min
-436P55	Ø.060 [Ø1.52]	15.5 oz Max	2.1 oz Min	-440P55	Ø.060 [Ø1.52]	15.5 oz Max	2.1 oz Min

### MOUNTING OPTIONS

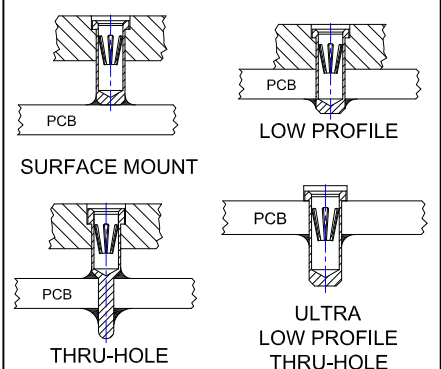

## ARTESYN *Continued* Socket Terminal Details Cross Section View Shown Units: in [mm]

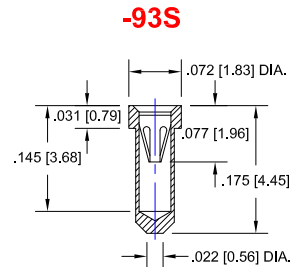
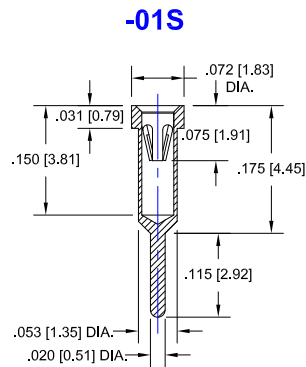

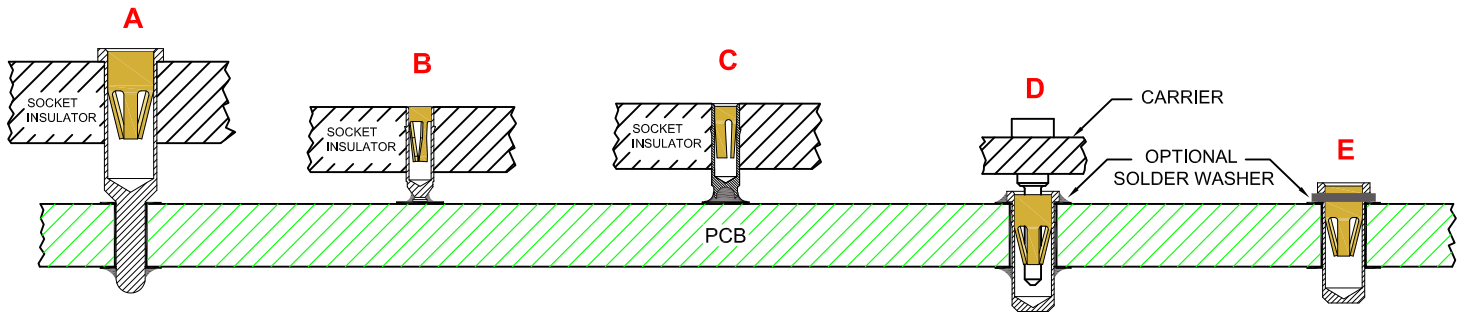

**THRU-HOLE  
SOCKET**

**SMD-SOCKET**

**SMD  
ROLLERBALL®  
SOCKET  
(PATENTED)**

**REMOVABLE  
CARRIER  
WITH ULTRA-LOW  
PROFILE PIN SOCKETS**

**INDIVIDUAL  
ULTRA-LOW PROFILE  
PIN SOCKETS  
(BEFORE SOLDERING)**

**ROLLERBALL®  
SOCKET**

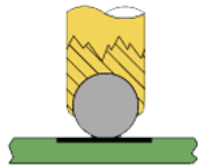

**BEFORE SOLDERING**

**ROLLERBALL®  
SOCKET**



**AFTER SOLDERING**

**A more reliable solder joint for surface mount applications !**

**ULTRA LOW PROFILE SIP/DIP/PGA CARRIER ASSEMBLY See 'D' above**

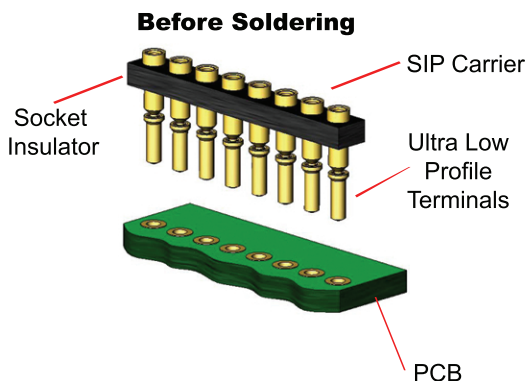

**During Soldering**

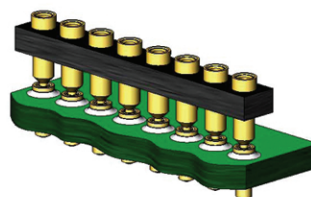

**After Soldering**

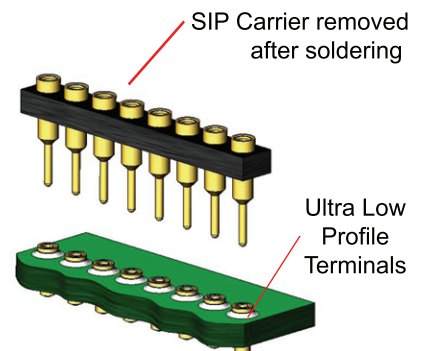

**Available with or without solder washer**