

KYOSEMI CORPORATION						
KYOSEMI CORPORATION Model Number	Andon Part Number Replace "XXX" with Terminal Type	Terminal Type		Pin Ø [in]	Figure Number	Page Number
		Thru-Hole	Surface Mount			
56	R079-0403-01T-XXX-R27-L14	274K	281K	.018	1	1
56B	R079-0403-01T-XXX-R27-L14	274K	281K	.018	1	1
46F	R100-SP03-02T-XXX-R27-L14	274K	281K	.018	2	1
H82	R100-0403-07T-XXX-R27-L14	211S	384S	.018	3	1
H82	R100-0403-07T-XXX-R27-L14	211S	384S	.018	3	1
DL	R100-0403-06T-XXX-R27-L14	75S	265S	.018	4	1
H33	R100-0404-02T-XXX-R27-L14	400T4	414T4	.012	5	1
H32	R098-0404-03T-XXX-R27-L14	75S	384S	.018	6	1

KYOSEMI CORPORATION

Top View Shown

Units: in [mm]

(FIG.1) KYOSEMI CORPORATION	ANDON PART NUMBER
	THRU-HOLE: R079-0403-01T-274K-R27-L14 SURFACE MOUNT: R079-0403-01T-281K-R27-L14

56
56B

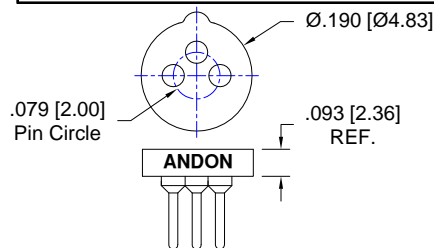

(FIG.2) KYOSEMI CORPORATION	ANDON PART NUMBER
	THRU-HOLE: R100-SP03-02T-274K-R27-L14 SURFACE MOUNT: R100-SP03-02T-281K-R27-L14

46F

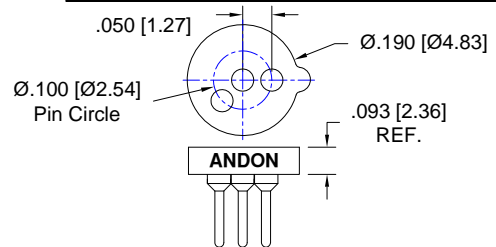

(FIG.3) KYOSEMI CORPORATION	ANDON PART NUMBER
	THRU-HOLE: R100-0403-07T-211S-R27-L14 SURFACE MOUNT: R100-0403-07T-384S-R27-L14

H8
H82

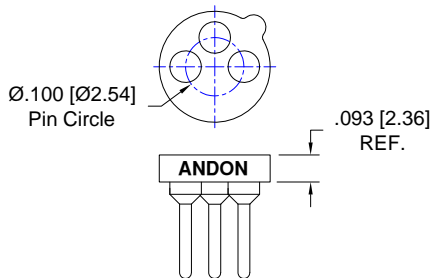

(FIG.4) KYOSEMI CORPORATION	ANDON PART NUMBER
	THRU-HOLE: R100-0403-06T-75S-R27-L14 SURFACE MOUNT: R100-0403-06T-265S-R27-L14

DL

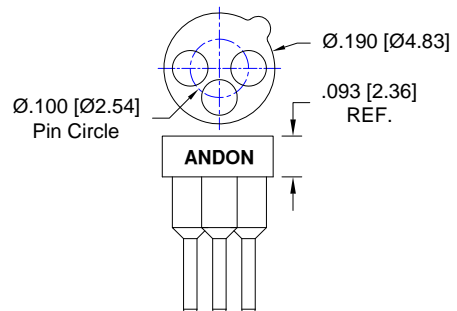

(FIG.5) KYOSEMI CORPORATION	ANDON PART NUMBER
	THRU-HOLE: R100-0404-02T-400T4-R27-L14 SURFACE MOUNT: R100-0404-02T-414T4-R27-L14

H33

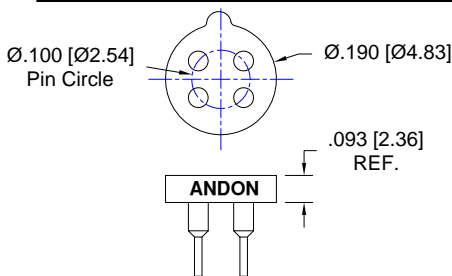

(FIG.6) KYOSEMI CORPORATION	ANDON PART NUMBER
	THRU-HOLE: R098-0404-03T-75S-R27-L14 SURFACE MOUNT: R098-0404-03T-265S-R27-L14

H32

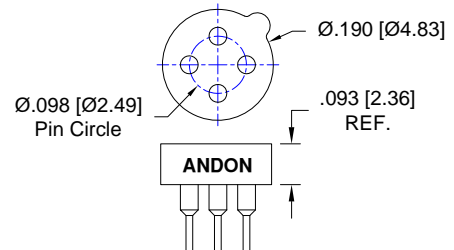

Socket Terminal Details

Cross Section View Shown Units: in [mm]

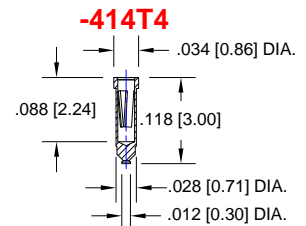
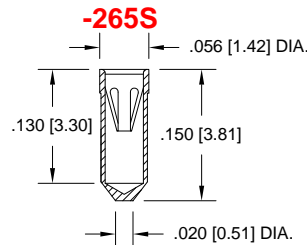
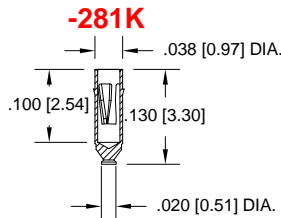
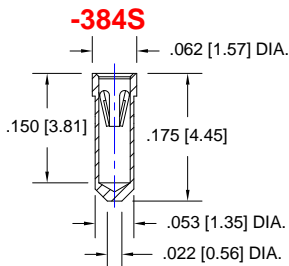
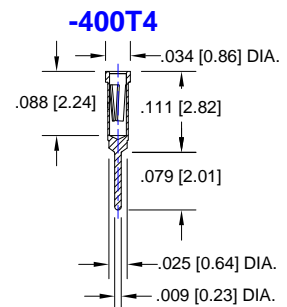
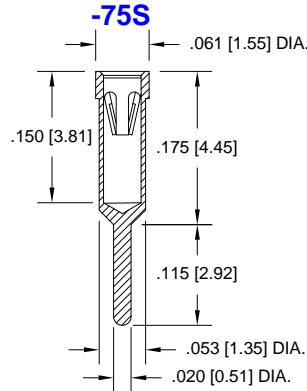
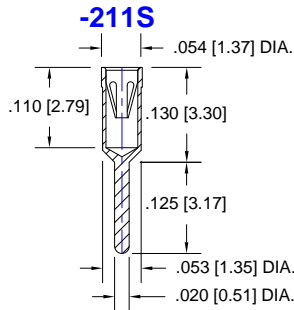
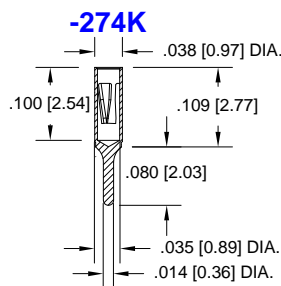

Technical Information

Material:

Insulator: Hi-Temp UL 94V-0
Terminal: Brass, per ASTM-B16
Contact: BeCu, Per ASTM-B194

Plating: RoHS COMPLIANT

R15 TERMINAL: GOLD / CONTACT: GOLD

R17 TERMINAL: TIN / CONTACT: GOLD

OTHER PLATINGS AVAILABLE

Terminal Acceptance and Forces

Thru Hole Terminals				Surface Mount Terminals			
Thru Hole Terminal	Accepts Pin Diameter	Insertion Force	Withdrawal Force	Surface Mount Terminal	Accepts Pin Diameter	Insertion Force	Withdrawal Force
-400T4	Ø.012 [Ø0.30]	1.1 oz Avg.	0.3 oz Min	-414T4	Ø.012 [Ø0.30]	1.1 oz Avg.	0.3 oz Min
-274K	Ø.018 [Ø0.46]	1.0 oz Max	0.3 oz Min	-281K	Ø.018 [Ø0.46]	1.0 oz Max	0.3 oz Min
-75S	Ø.018 [Ø0.46]	9.0 oz Max	2.0 oz Min	-265S	Ø.018 [Ø0.46]	9.0 oz Max	2.0 oz Min
-211S	Ø.018 [Ø0.46]	9.0 oz Max	2.0 oz Min	-384S	Ø.018 [Ø0.46]	9.0 oz Max	2.0 oz Min

MOUNTING OPTIONS

